

Parts lists for
Generators
25 through 200 KW

*50 KVA.
Low Fuel Shutdown
IMO/Gems LS-1700
Float Switch.*

P/N 1310 3010 55 Ed.0 1995-03

2M IP 4/95

From following serial number onwards:

699 000

Atlas Copco

Atlas Copco Compressors Inc.
161 Lower Westfield Road
Holyoke, MA 01041-0431

OWNERSHIP DATA

Unit model: _____

Owner's machine no.: _____

Delivery date: _____

Unit service no.: _____

Service plan: _____

Engine serial no.: _____

First start-up date: _____

Selected Lubricants

Compressor: _____

Capacity: _____

Printed Matter Nos.

Atlas Copco instruction book: _____

Atlas Copco logbook: _____

Atlas Copco parts book: _____

Engine parts list: _____

Engine parts book: _____

Local Atlas Copco Representative

Name: _____

Address: _____

Telephone: _____

Contact persons:

Service: _____

Telefax: _____

Parts: _____

Example parts list

Ref	Note	Sub	Part No	Description	Qty
1	1)		1513 0136 80	Canopy	1
2	1		1513 0274 60	Support	1
3		•	1619 2766 00	Bolt	2

Explanation of columns:

Ref. - Reference number. Relates a part in list and drawing. "x" means that the part is not shown on the drawing. "-" indicates the beginning of a new list item.

Note - A number followed by a bracket, e.g. 1), refers to a footnote.

A number in bold, e.g. 1, refers to a "Service Kit". For the "Service Kit" number, see below list. Parts of one "Service Kit" may be spread over several pages.

Sub - Parts followed by one dot are comprised in the assembly(ies) listed above the first dot.

Part No-Part number. "---" directs to consult another list of which the heading mostly has the same designation. "****" means that the part is not available as spare part.

Description - Mostly part names. When machine types, Classification Societies, dimensions, etc. are mentioned under the same "Designation", look carefully for the part number for your specific equipment. When a selection is to be made, the various selections are indented and preceded by a dash.

Qty - A number indicating the quantity of parts. The quantity is only related to its corresponding reference number ("Ref") and may differ from the total quantity of this part for the entire unit. For parts of an assembly the quantity mentioned is for one assembly. "AR" means "as required" : bulk material or quantity to be determined.

ORDERING PARTS

Always quote the part number, "Designation" and quantity of the desired parts as well as type designation and serial number of the unit.

Contents

Description	Page
Control Panel 25, 35, 60 KW	4
Control Panel 100, 125, 150, 175 KW	5
Generator Controls	6
Fuel System	6
Cooling Assembly	6
Generator Assembly	7
Lifting Bail	7
Engine Assembly	7
Generator Base	7
Muffler Assembly	7
Air Filter Assembly	8
Engine/Generator Mounts	8
Decals	8
Battery Assembly	9
Bodywork 25, 35, 60 KW	10
Bodywork 100, 125, 150, 175 KW	11
Wheeled Frame Assy. 25KW Single Axle	12
Wheeled Frame Assy. 60KW Single Axle	13
Whelled Frame Assy. 60KW with Hydraulic Surge Brakes	14
Wheeled Frame Assy. 60KW Tandem Axle	15
Wheeled Frame Assy. 100KW Tandem Axle	16
Auxillary Fuel Tank	17

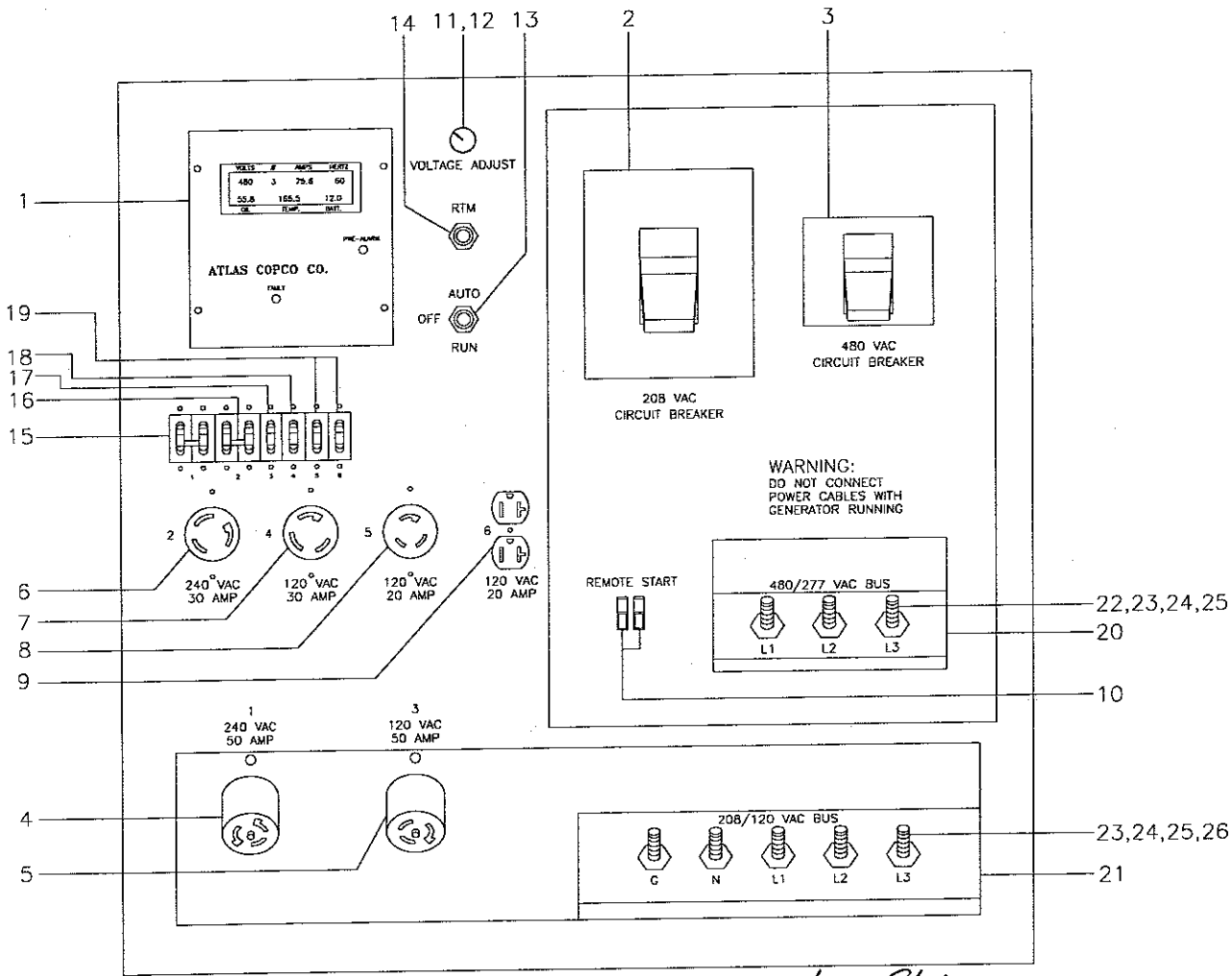

Computer Chip
1310-0332-70

Control Panel 25, 35, 60 KW

Ref	Note	Sub	Part No	Description	Qty	Ref	Note	Sub	Part No	Description	Qty
1			1310 0328 00	Engine Controller	1	13			1310 0330 15	Switch, Start	1
2			1310 0327 45	Circuit Breaker 90A, 25KW Unit	1	14			1310 0330 16	Switch, Running Time Meter	1
			1310 0327 48	Circuit Breaker 125A, 35KW Unit	1	15			1310 0327 52	Circuit Breaker 50A, 2 Pole	1
			1310 0327 49	Circuit Breaker 225A, 60KW Unit	1	16			1310 0327 54	Circuit Breaker 30A, 2 Pole	1
3			1310 0327 44	Circuit Breaker 40A, 25KW Unit	1	17			1310 0327 46	Circuit Breaker 50A, 1 Pole	1
			1310 0327 55	Circuit Breaker 50A, 35KW Unit	1	18			1310 0327 47	Circuit Breaker 30A, 1 Pole	1
			1310 0327 45	Circuit Breaker 90A, 60KW Unit	1	19			1310 0327 53	Circuit Breaker 20A, 1 Pole	2
4			1310 0327 39	Receptacle 50A, 120/240V	1	20			1310 0329 14	Panel 480V, 3 Pin	1
5			1310 0327 38	Receptacle 50A, 120V	1	21			1310 0329 15	Panel 208V, 5 Pin	1
6			1310 0327 36	Receptacle 30A, 240V	1	22			1310 0329 16	Brass Stud 1/2-13	8
7			1310 0327 37	Receptacle 30A, 120V	1	23			0333 2238 00	Lockwasher, Brass	16
8			1310 0327 35	Receptacle 20A, 120V	1	24			1310 0327 06	Flatwasher, Brass	16
9			1310 0327 34	Receptacle 20A, 120V	1	25			1310 0327 05	Nut 1/2-13, Brass	16
10			1310 0328 04	Terminal Block	2						
11			1310 0330 14	Rheostat, Voltage Adjust	1						
12			1310 0330 20	Knob, Voltage Adjust	1						
									1310 9028 72		

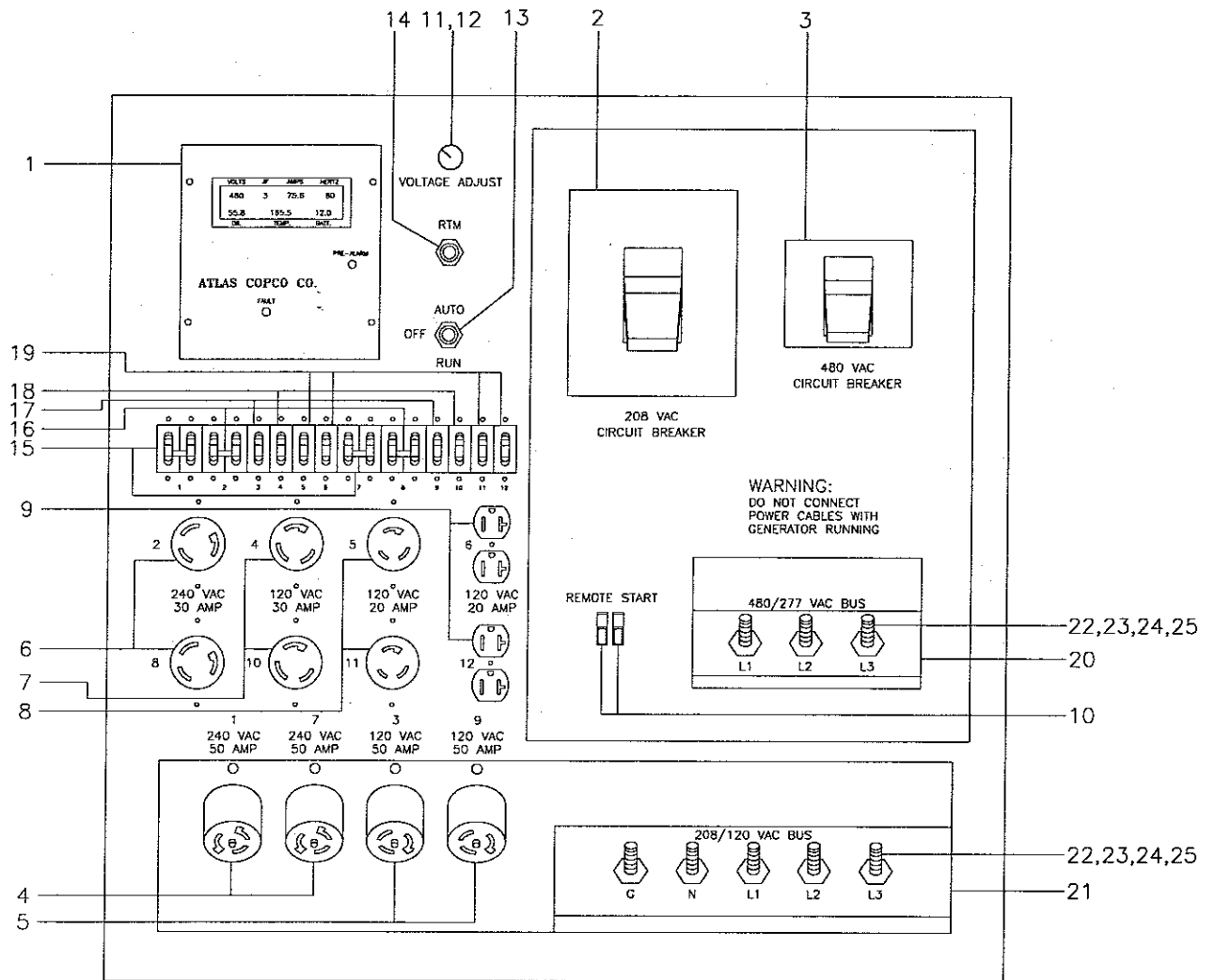

Control Panel 100, 125, 150, 175 KW

Ref	Note	Sub	Part No	Description	Qty	Ref	Note	Sub	Part No	Description	Qty
1			1310 0328 00	Engine Controller	1	12			1310 0330 20	Knob, Voltage Adjust	1
2			1310 0327 51	Circuit Breaker 350A, 100KW Unit	1	13			1310 0330 15	Start Switch	1
			1310 0327 40	Circuit Breaker 450A, 125KW Unit	1	14			1310 0330 16	Switch, Running Time Meter	1
			1310 0327 42	Circuit Breaker 500A, 150KW Unit	1	15			1310 0327 52	Circuit Breaker 50A, 2 Pole	2
			1310 0327 56	Circuit Breaker 600A, 175KW Unit	1	16			1310 0327 54	Circuit Breaker 30A, 2 Pole	2
3			1310 0327 50	Circuit Breaker 150A, 100KW Unit	1	17			1310 0327 46	Circuit Breaker 50A, 1 Pole	2
			1310 0327 41	Circuit Breaker 225A, 125, 150KW Unit 1	1	18			1310 0327 47	Circuit Breaker 30A, 1 Pole	2
			1310 0327 43	Circuit Breaker 250A, 175KW Unit	1	19			1310 0327 53	Circuit Breaker 20A, 1 Pole	4
4			1310 0327 39	Receptacle 50A, /240V	2	20			1310 0329 14	Panel 480V, 3 Pin	1
5			1310 0327 38	Receptacle 50A, 120V	2	21			1310 0329 15	Panel 208V, 5 Pin	1
6			1310 0327 36	Receptacle 30A, 240V	2	22			1310 0329 16	Brass Stud 1/2-13	8
7			1310 0327 37	Receptacle 30A, 120V	2	23			0333 2238 00	Lockwasher, Brass	16
8			1310 0327 35	Receptacle 20A, 120V	2	24			1310 0327 06	Flatwasher, Brass	16
9			1310 0327 34	Receptacle 20A, 120V	2	25			1310 0327 05	Nut 1/2-13, Brass	16
10			1310 0328 04	Terminal Block	2						
11			1310 0330 14	Rheostat, Voltage Adjust	1						
									1310 9028 73		

Generator Controls

Ref	Note	Sub	Part No	Description	Qty
1			1310 0328 01	Oil Pressure Sender	1
2			1310 0328 02	Water Temp. Sender	1
3			1310 0330 13	Current Transformer	3
4			1310 0312 67	Starter Relay	1
5			1310 0330 17	Starter Relay Bracket 25 KW	1
6			1310 0330 18	Starter Relay Bracket 35,60,100 KW1	1
7			1310 0330 19	Starter Relay Bracket 125,150,175 KW	1
8			1310 0328 03	Magnetic pick-up	1
9			1089 0568 01	Water level switch	1

Ref	Note	Sub	Part No	Description	Qty
10			1310 0327 11	S.S. screw countersink	14
11			1310 0327 10	S.S. screw slot head	14
12			1310 0327 09	S.S. screw slot head	32
13			1310 0327 12	S.S. screw pan head phillips	10
14			1310 0329 52	Copper link	6
15			1310 0330 23	Spacer	2
16			1310 0330 24	Micro switch	2
17			1310 0330 28	Screw #10-32 x .875	2
18			NUT01095	Locknut #10-32	32

1310-0334795E 250 Volt. Reg

Fuel System

Ref	Note	Sub	Part No	Description	Qty
1			1310 0329 11	Fuel tank 25 KW	1
2			1310 0329 12	Fuel tank 35 KW	1
3			1310 0329 13	Fuel tank 60 - 175 KW	1
4			1310 0332 66	Fuel cap	1
5			1310 0327 33	Fuel level gauge	1
6			1310 0328 05	Fill hose clamps	2
7			1310 0329 21	Fuel tank hold down bolt	2
8			0292 1306 00	Nylock nut	2
9			0301 2344 00	Flat washer	2
10			1310 0327 32	Fuel level tank kit	1
11			1310 0327 16	Fuel tank fitting (supply)	1
12			1310 0327 08	Fuel tank fitting (return)	1
13			1310 0327 29	Brass swivel (supply)	4
14			1310 0327 28	Brass swivel (return)	1
15			1310 0327 25	Return line connector	1
16			1310 0327 18	Copper tube connector	1
17			1310 0327 17	Elbow (water separator)	2
18			1310 0312 68	Copper tubing	1
19			1310 0327 15	Elbow (fuel pump)	1
20			1310 0311 97	Fuel hose (return)	6

Ref	Note	Sub	Part No	Description	Qty
21			1310 0327 25	Fuel hose (from tank)	6
22			1310 0327 24	Fuel hose (from separator)	5
23			1310 0327 63	Water separator	1
24			1310 0329 17	Water separator bracket	1
25			1310 0327 21	Fitting in separator	2
26			1310 0327 20	Fitting (separator drain)	1
27			1310 0327 19	Separator drain valve	1
28			1310 0327 24	Separator drain hose	6 ft.
29			1310 0327 29	Separator hose fitting	1
30			1310 0327 26	Separator hose fitting	1
31			1310 0327 13	Fitting (tank drain)	1
32			1310 0327 23	Drain hose	2 ft.
33			1310 0327 31	Bulkhead (drain hose)	1 ft.
34			1310 0327 30	Fitting (drain hose)	2
35			1310 0327 14	Fitting (drain valve)	1
36			9710 5321 00	Valve (fuel drain 1/2")	1
37			1310 0327 07	Hex nipple (fuel drain)	1
38			1310 0329 18	Dip tube 25 & 35 KW	1
39			1310 0329 19	Drop tube 60 - 175 KW	1

Cooling Assembly

Ref	Note	Sub	Part No	Description	Qty
1			1310 0329 26	Radiator 25, 35 KW	1
2			1310 0329 27	Radiator 60 KW	1
3			1310 0329 28	Radiator 100 KW	1
4			1310 0329 29	Radiator 125, 150 KW	1
5			1310 0329 30	Radiator 175 KW	1
6			1310 0329 31	Fan guard 25, 35, 60 KW	1
7			1310 0329 32	Fan guard 100 KW	1
8			1310 0329 33	Fan guard 125, 150, 175 KW	1
9			0144 3285 03	Bolt	6
10			0301 2344 00	Flatwasher	6
11			0333 2229 00	Lock washer	6
12			1310 0329 34	Fan 25 KW	1
13			1310 0329 35	Fan 35, 60 KW	1
14			1310 0329 36	Fan 100 KW	1
15			1310 0329 37	Fan 125 KW	1
16			1310 0329 38	Fan 150, 175 KW --	1
17			0144 3287 03	Bolt	4

Ref	Note	Sub	Part No	Description	Qty
18			0333 2229 00	Lock washer	4
19				Upper water tube	1
20				Radiator hose	2
21			1310 0323 83	Stainless hose clamp	4
22				Lower water tube	1
23				Radiator hose 2-3/8 i.d.	3
24			1310 0323 83	Stainless hose clamp	4
25			1310 0317 69	Overflow bottle	1
26			0144 3206 03	Bolt	2
27			1301 2335 00	Flatwasher	2
28			0333 2121 00	Lock washer	2
29			1310 0328 06	Drain bulkhead	1
30			1310 0327 26	Connector - drain hose	1
31			1310 0327 29	Connector - drain hose	1
32			1310 0327 24	Hose - drain	3 ft.
33			1310 0327 19	Valve - drain	2
34			1310 0329 39	Bracket - overflow bottle	1

Generator Assembly

Ref	Note	Sub	Part No	Description	Qty
1			1310 0328 15	Lima Generator 25 KW	1
2			1310 0328 16	Lima Generator 35 KW	1
3			1310 0328 17	Lima Generator 60 KW	1
4			1310 0328 18	Lima Generator 100 KW	1
5			1310 0328 19	Lima Generator 125 KW	1
6			1310 0328 20	Lima Generator 150 KW	1
7			1310 0328 21	Lima Generator 175 KW	1
8			0211 5248 00	Socket head bolt, gr. 8	8
9			0333 229 00	Lock washer - high collar	8
10			0144 3288 03	Bolt, gr. 5	12
11			0222 2229 00	Lock washer	12
12			1310 2526 23	Conduit elbow .75"	2
13			1310 2515 63	Conduit elbow 1.25" 25, 35,60 KW	2

Ref	Note	Sub	Part No	Description	Qty
14			1310 2515 67	Conduit elbow 2.00" 100, 125, 150, 175 KW	2
15			1310 2520 93	Conduit connector 1.25" 25, 35, 60 KW	2
16			1310 2515 68	Conduit connector 2.00" 100, 125, 150, 175 KW	2
17			1310 2526 62	Conduit 3/4"	1
18			1310 2515 62	Conduit 1.25" 25,35,60 KW	2
19			1310 2028 37	Conduit 2.00" 100, 125, 150, 175 KW	2
20			1310 0328 07	Rotary switch 25, 35 KW	1
21			1310 0328 08	Rotary switch 60 KW	1
22			1310 0328 09	Rotary switch 100 KW	1
23			1310 0328 10	Rotary switch 125, 150, 175 KW	1

13100335 46 25+35 KW
Rot. Switch

Lifting Bail

Ref	Note	Sub	Part No	Description	Qty
1			1310 0328 30	Lifting eye	2
2			1310 0329 22	A36 Lifting stud 3/4x59-3/4 35,60 KW	2
3			1310 0329 23	A36 Lifting stud 1x59-3/4 100, 125, 150 KW	2
4			0268 3211 00	Jamb nut	10
5			0333 2147 00	Lock washer 3/4"	6

Engine Assembly

Ref	Note	Sub	Part No	Description	Qty
1			1310 0329 54	Engine, 3179 25 KW	1
2			1310 0329 55	Engine, 4039D 35 KW	1
3			1310 0329 56	Engine, 4039T 60 KW	1
4			1310 0329 57	Engine, 6059T 100 KW	1
5			1310 0329 58	Engine, 6076T 125 KW	1
6			1310 0329 59	Engine, 6076A-250 150 KW	1
7			1310 0329 60	Engine, 6076A-300 175 KW	1
8			1310 0316 10	Exhaust seal 25,35 KW	1
9			1310 0328 11	Turbo outlet seal 60,100, 125,150,175 KW	1
10			1310 0316 09	Muffler clamp 25,35 KW	2

Ref	Note	Sub	Part No	Description	Qty
11			1310 0328 12	Muffler clamp 60,100,125, 150,175 KW	2
12			1310 0327 22	Adapter (oil drain)	1
13			0560 020H 07	Brass st. elbow	1
14			1310 2503 47	Brass nipple	1
15			9710 5321 00	Valve 1/2" (oil drain)	1
16			1310 0327 31	Bulkhead (oil drain)	1
17			1310 0327 14	Connector (drain valve)	1
18			1310 0327 23	Drain hose	4
19			1310 0327 27	Hose end	1
20			1310 0327 30	Hose end	1
21			1310 0328 13	Fanspacer 25,35,100 KW	1

Generator Base

Ref	Note	Sub	Part No	Description	Qty
1			1310 0328 25	Generator base 25 KW	1
2			1310 0328 24	Generator base 35,60 KW	1
3			1310 0328 23	Generator base 100,125, 150,175 KW	1

Muffler Assembly

Ref	Note	Sub	Part No	Description	Qty
1			1310 0327 88	Muffler 25,35 KW	1
2			1310 0327 89	Muffler 60 KW	1
3			1310 0327 90	Muffler 100,125,150,175 KW	1
4			1310 0321 33	Clamp 25,35 KW	1
5			1310 0329 40	Flange assembly 4" 25,35 KW	1

Ref	Note	Sub	Part No	Description	Qty
6			1310 0329 41	Flange assembly 5" 60,100, 125,150,175 KW	1
7			1310 0321 34	Rain cap 4" 25,35,60 KW	1
8			1310 0328 26	Rain cap 5" 100,125, 150,175 KW	1
9			1310 0327 87	Stainless steel rivet	8

Air Filter Assembly

Ref	Note	Sub	Part No	Description	Qty
1			1310 0327 57	Air filter 25,35,60 KW	1
2			1310 0327 58	Air filter 100,125 KW	1
3			1310 0327 59	Air filter 150,175 KW	1
4			1310 0327 60	Filter mounting bands 8" 25, 35,60 KW	2
5			1310 0327 61	Filter mounting bands 10.5" 100,125 KW	2
6			1310 0327 62	Filter mounting bands 12" 150, 175 KW	2
7			1310 0330 11	Hump hose 3" x 4" 100 KW	1
8			1310 0309 42	Rubber elbow 3" 25,35,60 KW	1
9			1310 0325 58	Rubber elbow 4" 100 KW	2
10			1310 0325 58	Rubber elbow 4" 125 KW	1
11			1310 0330 12	Rubber elbow 5"x4" 150, 175 KW	1
12			1310 0332 67	Rubber elbow 3" x 45° 25, 35,60 KW	1

Ref	Note	Sub	Part No	Description	Qty
13			1310 0325 56	Clamp 3" 25,35,60 KW	4
14			1310 0325 56	Clamp 3" 100 KW	1
15			1310 0321 63	Clamp 4" 100,125 KW	4
16				Hose 4" i.d. x 5"L 125,150, 175 KW	1
17				Pipe 4"o.d. x 14"L 100,125, 150,175 KW	1
18			0144 3248 03	Screw 25,35,60 KW	4
19			0301 2335 00	Flat washer 25,35,60 KW	4
20			0333 2225 00	Lock washer 25,35,60 KW	4
21			0268 3205 00	Nut 25,35,60 KW	4
22			0144 3248 03	Screw 100,125,150,175 KW	8
23			0301 2335 00	Flat washer 100,125,150, 175 KW	8
24			0333 2225 00	Lock washer 100,125,150, 175 KW	8
25			0268 3205 00	Nut 100,125,150,175 KW	8

Engine/Generator Mounts

Ref	Note	Sub	Part No	Description	Qty
1			1310 0329 48	Engine front foot 25,35,60,100 KW	1
2			1310 0329 49	Engine front foot 25,35,60,100 KW	1
3			1310 0329 50	Engine front foot 125,150,175 KW	2
4			1310 0329 51	Spacer 125,150,175 KW	2
5			1310 0329 51	Spacer 100 KW	4
6			1310 0#29 44	Rubber mount 5 KW	2
7			1310 0329 44	Rubber mount 5,60 KW	4
8			1310 0329 45	Rubber mount 25 KW	2
9			1310 0329 46	Rubber mount (rear) 125,150 KW	2
10			1310 0329 46	Rubber mount 100 KW	4
11			1310 0329 47	Rubber mount 25,150 KW	2
12			1310 0329 47	Rubber mount 75 KW	4
13			0144 3444 00	Bolt - 5/8-11 x 1 5,35,60,100 KW	4
14			0144 3444 00	Bolt - 5/8-11 x 1125,150,175 KW	8
15			0333 2243 00	Lock washer 5,35,60,100 KW	4
16			0333 2243 00	Lock washer 125,150,175 KW	8
17			0144 3363 03	Bolt 1/2-13x1-1/4	8
18			0301 2358 00	Flat washer	12
19			0333 2238 00	Lock washer	8
20			0268 3208 00	Nut 1/2-13	8

Ref	Note	Sub	Part No	Description	Qty
21			1310 0327 96	Bolt - 1/2-13x4 fully threaded 25,35, 60 KW	4
22			1310 0327 97	Bolt - 1/2-13x5 fully threaded 100 KW	4
23			1310 0332 68	Bolt - 5/8-11x4 fully threaded 150 KW	2
24			1310 0332 68	Bolt - 5/8-11x4 fully threaded 125,175 KW	4
25			1310 0332 69	Bolt - 5/8-11x5-1/2 fully threaded 125,150 KW	2
26			1310 0327 98	Washer - large rubber 25,35,60 KW	4
27			1310 0328 28	Washer - large rubber 100,125, 150,175 KW	4
28			1310 0327 99	Washer - large steel 25,35,60 KW	4
29			1310 0328 29	Washer - large steel 100,125, 150,175 KW	4
30			0333 2238 00	Lock washer 25,35,60 KW	4
31			0301 2179 00	Lock washer 100,125,150, 175 KW	4
32			0268 3208 00	Nut 1/2-13 25,35,60 KW	4
33			0268 3210 00	Nut 5/8-11 100,125,150,175 KW	4

Decals

Ref	Note	Sub	Part No	Description	Qty
1			1310 3111 53	Label* Diesel Fuel...30 gal. 25 KW	1
2			1310 3111 54	Label* Diesel Fuel...50 gal. 35, 60 KW	1
3			1310 3111 55	Label* Diesel Fuel...85 gal. 100,125,150,175 KW	1
4			1310 3111 56	Label* Waring 280 Volts	1
5			1310 3111 57	Label* Waring 480 Volts	1
6			1310 3111 58	Label* Oil Drain	1
7			1310 3111 59	Label* Water Drain	1
8			1310 3111 60	Label* Fuel Drain	1
9			1310 3111 61	Label* Fuel In	1
10			1310 3111 62	Label* Fuel Out	1

Ref	Note	Sub	Part No	Description	Qty
11			1310 3111 63	Label* Internal/External...	1
12			1310 3111 64	Label* Lifting Instructions	2
13			1310 3111 65	Label* Don't Switch...	1
14			0690 1132 00	Label* Atlas Copco Logo	4
15			1310 3109 41	Label* Auto Start Info.	2
16			1310 3111 66	Label* 25 KW 25 KW	2
17			1310 3111 67	Label* 35 KW 35 KW	2
18			1310 3111 68	Label* 60 KW 60 KW	2
19			1310 3111 69	Label* 100 KW 100 KW	2
20			1310 3111 70	Label* 125 KW 125 KW	2
21			1310 3111 71	Label* 150 KW 150 KW	2
22			1310 3111 72	Label* 175 KW 175 KW	2

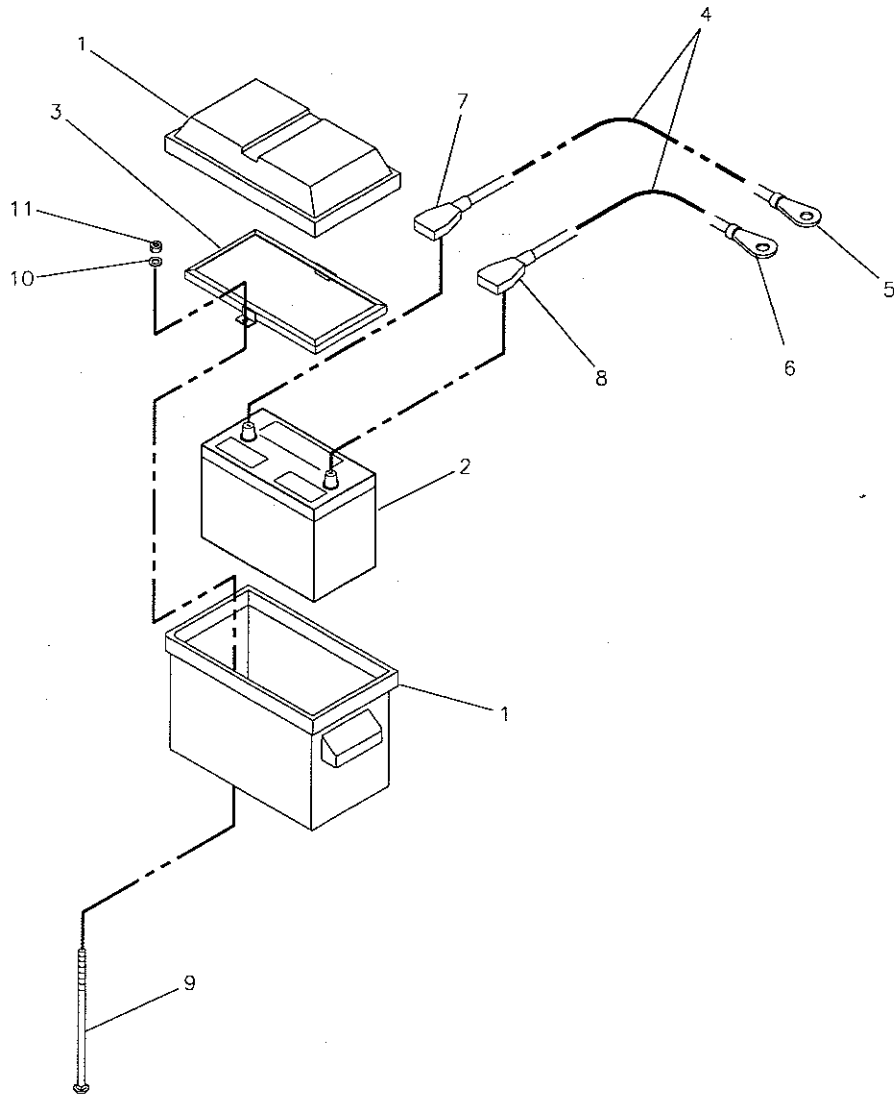

Battery Assembly

Ref	Note	Sub	Part No	Description	Qty
1			1310 0329 42	Battery Box	1
			****	Cover - Battery Box	1
2			1310 0327 94	Battery	1
3			1310 0329 43	Battery Holddown	1
4			0019 8402 53	Wire 1/0 AWG	3FT
5			1310 0327 91	Wire Terminal 1/0 AWG x 1/2"Stud	1
6			1310 2507 81	Wire Terminal 1/0 AWG x 3/8"Stud	1
7			1310 0327 93	Battery Terminal 1/0 AWG x Neg.	1
8			1310 0327 92	Battery Terminal 1/0 AWG x Pos.	1
9			1310 0327 95	Carriage Bolt 5/16-18 x 11" Lg.	2
10			0301 2335 00	Flatwasher	2
11			0268 3205 00	Nut 5/16-18	2

1310 9029 36

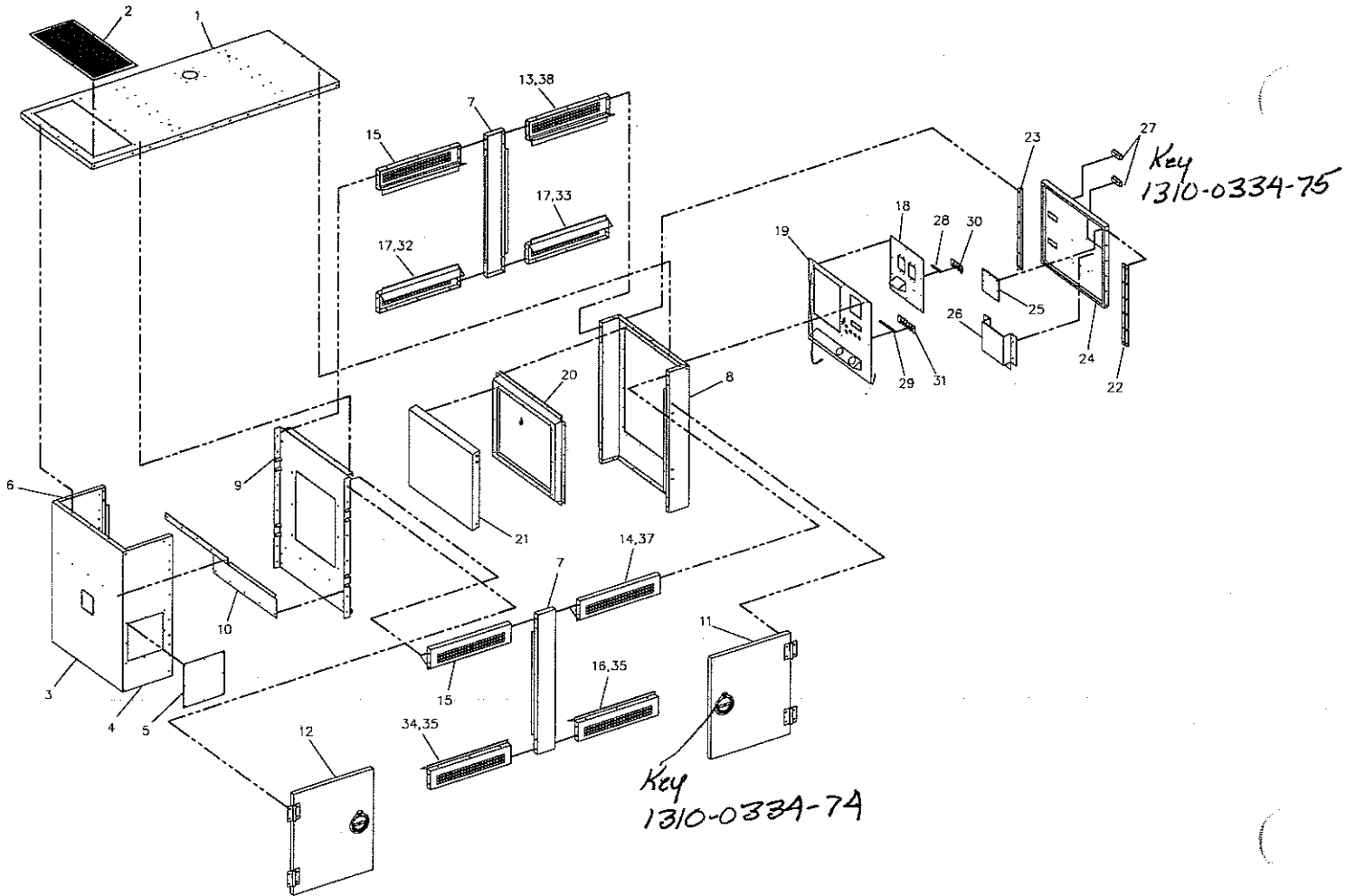

Bodywork 25, 35, 60 KW

Ref	Note	Sub	Part No	Description	Qty	Ref	Note	Sub	Part No	Description	Qty
1			1310 0331 14	Roof 35,60 KW	1	16			1310 0330 99	Bottom Jamb Assembly 35,60 KW	1
			1310 0330 97	Roof 25 KW	1	17			1310 0330 98	Bottom Jamb Assembly 35,60 KW	2
2			1310 0331 13	Exhaust Grill 35,60 KW	1	18			1310 0330 82	Circuit Breaker Panel 25,35,60 KW	1
			1310 0330 96	Exhaust Grill 25 KW	1	19			1310 0330 81	Control Panel 25,35,60 KW	1
3			1310 0331 12	End Panel 35,60 KW	1	20			1310 0330 80	Panel Frame 25,35,60 KW	1
			1310 0330 95	End Panel 25 KW	1	21			1310 0330 79	Control Box 25,35,60 KW	1
4			1310 0331 11	Access Panel	1	22			1310 0330 78	Hinge 25,35,60 KW	1
5			1310 0331 10	Access Plate	1	23			1310 0330 77	Door Stop	1
6			1310 0331 09	Filler Panel 35,60 KW	1	24			1310 0330 76	Door	1
7			1310 0331 08	Center Post 35,60 KW	2	25			1310 0330 75	Window	1
			1310 0330 94	Center Post 25 KW	2	26			1310 0330 74	Shelf	1
8			1310 0331 07	End Panel 35,60 KW	1	27			1310 0330 73	Door Latch	2
			1310 0330 93	End Panel 25 KW	1	28			1310 0330 72	Hinge	1
9			1310 0331 06	Radiator Baffle 35,60 KW	1	29			1310 0330 71	Hinge	1
			1310 0330 90	Radiator Baffle 25 KW	1	30			1310 0330 26	Terminal Cover	1
10			1310 0331 05	Baffle 35,60 KW	1	31			1310 0330 25	Terminal Cover	1
			1310 0330 89	Baffle 25 KW	1	32			1310 0330 83	Bottom Jamb Assembly 25 KW	1
11			1310 0331 04	Door Assembly R.H. 35,60 KW	2	33			1310 0330 84	Bottom Jamb Assembly 25 KW	1
11			1310 0330 88	Door Assembly R.H. 25 KW	2	34			1310 0330 70	Bottom Jamb Assembly 35,60 KW	1
12			1310 0331 03	Door Assembly L.H. 35,60KW	2	35			1310 0330 91	Bottom Jamb Assembly 25 KW	2
			1310 0330 87	Door Assembly L.H. 25 KW	2	36			1310 0330 85	Top Jamb Assembly 25 KW	1
13			1310 0331 02	Top Jamb Assembly 35,60 KW	1	37			1310 0330 86	Top Jamb Assembly 25 KW	1
14			1310 0331 01	Top Jamb Assembly 35,60 KW	1						
15			1310 0331 00	Top Jamb Assembly 35,60 KW	2						
			1310 0330 92	Top Jamb Assembly 25 KW	2						
									1310 9028 69		

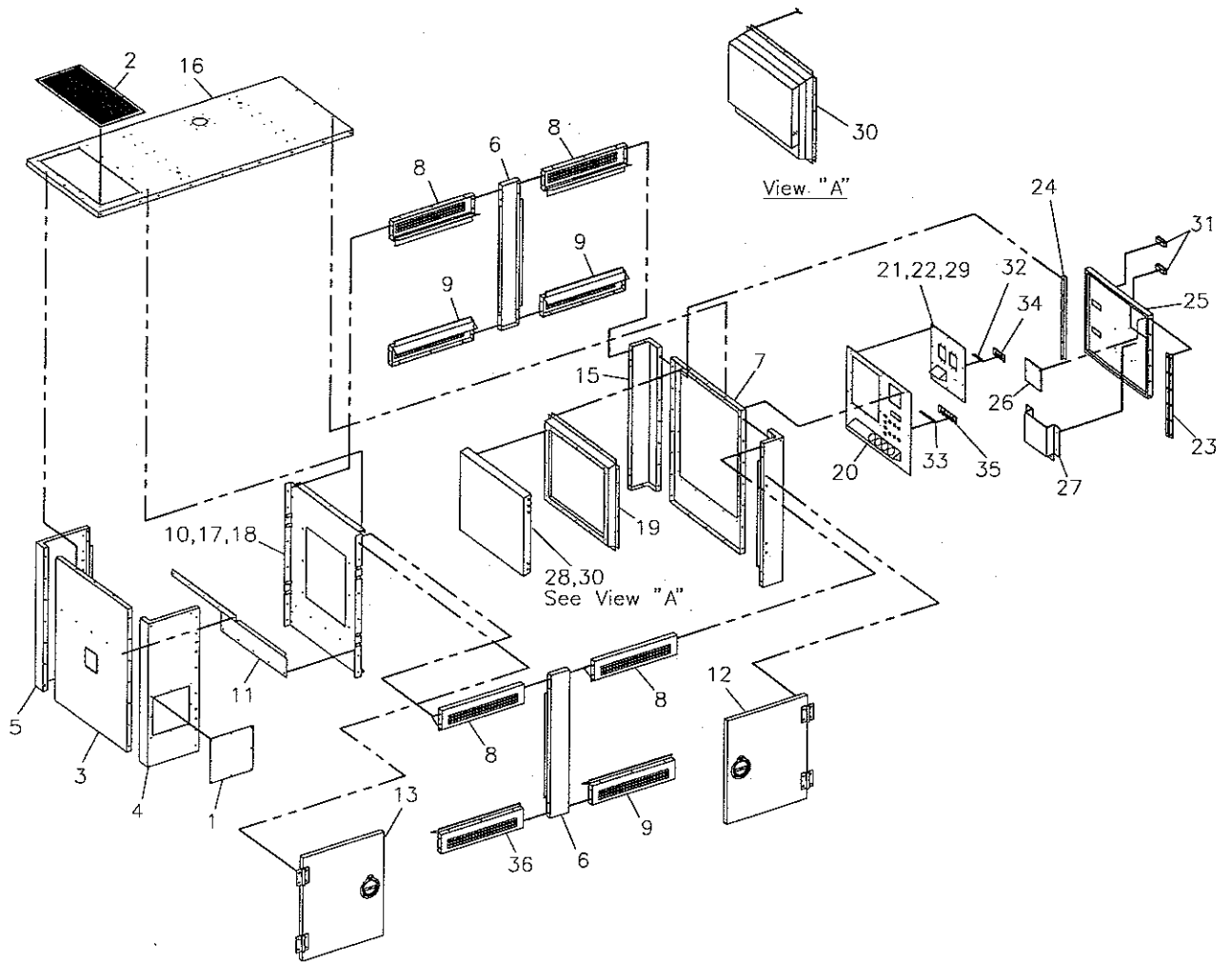

Bodywork 100, 125, 150, 175 KW

Ref	Note	Sub	Part No	Description	Qty
1			1310 0331 10	Access Plate	1
2			1310 0331 38	Exhaust Grill	1
3			1310 0331 37	End Panel	1
4			1310 0331 36	Access Panel	1
5			1310 0331 35	Filler Panel	1
6			1310 0331 34	Center Post	2
7			1310 0331 33	End Panel	1
8			1310 0331 32	Top Jamb Assembly	4
9			1310 0331 31	Bottom Jamb Assembly	3
10			1310 0331 30	Radiator Baffle 100 KW	1
11			1310 0331 29	Baffle	1
12			1310 0331 28	Door Assembly, R.H.	2
13			1310 0331 27	Door Assembly, L.H.	2
14			1310 0331 26	Corner Post	1
15			1310 0331 25	Corner Post	1
16			1310 0331 24	Roof	1
17			1310 0331 23	Radiator Baffle 125,150 KW	1
18			1310 0331 22	Radiator Baffle 175 KW	1
19			1310 0330 80	Panel Frame	1

Ref	Note	Sub	Part No	Description	Qty
20			1310 0331 21	Control Panel	1
21			1310 0331 20	Circuit Breaker Panel 100 KW	1
22			1310 0331 19	Circuit Breaker Panel 125,150 KW	1
23			1310 0330 78	Hinge	1
24			1310 0330 77	Door Stop	1
25			1310 0330 76	Door	1
26			1310 0330 75	Window	1
27			1310 0330 74	Shelf	1
28			1310 0331 18	Control Box 100,125,150 KW	1
29			1310 0331 17	Circuit Breaker Panel 175 KW	1
30			1310 0331 16	Control Box 175 KW	1
31			1310 0330 73	Door Latch	2
32			1310 0330 72	Hinge	1
33			1310 0330 71	Hinge	1
34			1310 0330 26	Terminal Cover	1
35			1310 0330 25	Terminal Cover	1
36			1310 0331 15	Bottom Jamb Assembly	1

1310 9028 70

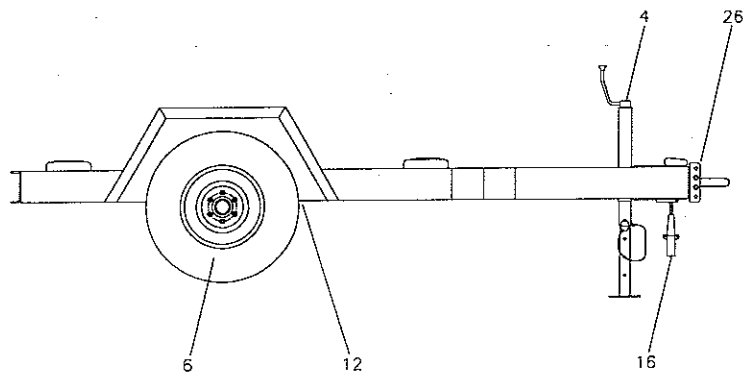
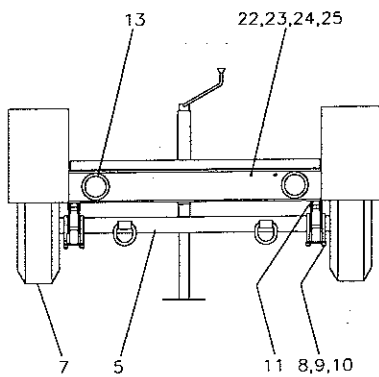
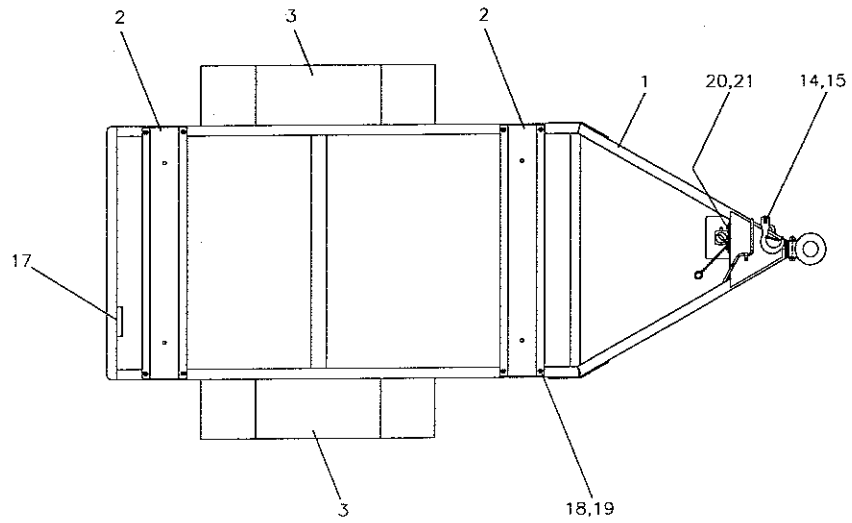

Wheeled Frame Assy. 25KW Single Axle

Ref	Note	Sub	Part No	Description	Qty
1			1310 0332 38	Frame Assembly	1
2			1310 0332 39	Cross Member	2
3			1310 0332 34	Fender	2
4			1310 0332 21	Jack Stand	1
5			1310 0332 40	Axle Beam Assembly	1
6			1310 0322 82	Wheel	2
7			1310 1480 00	Tire 7.00 x 15 LT, 8 Ply	2
8			1310 0314 35	Nut - Shackle * Locknut	6
9			1310 0332 29	Bolt - Shackle	2
10			1310 0314 36	Shackle Link	2
11			1310 0332 43	Hanger - Rear Spring	2
12			1310 0332 23	Hanger - Front Spring	2
13			1310 0332 28	Lamp * Stop, Tail, Turn	2
14			1310 0306 01	Safety Chain	1
15			1310 0332 41	Hook - Clevis Sling	1

Ref	Note	Sub	Part No	Description	Qty
16			1310 0317 23	Plug - Seven Hole	1
17			1310 0332 31	Terminal Block with Cover	1
18			0144 3362 00	Screw 1/2-13 x 1" Lg.	8
19			0333 2238 00	Lockwasher	8
20			0144 3285 03	Screw 3/8-16 x 3/4 Lg.	6
21			0333 2229 00	Lockwasher	6
22			0144 3208 03	Screw 1/4-20 x 1" Lg.	2
23			0268 3204 00	Nut 1/4-20	2
24			0301 2327 00	Flatwasher	2
25			0333 2121 00	Lockwasher	2
26			1310 0332 44	Pintel Eye Assembly	1
Tire/Wheel Assembly P/N 1310 0330 69					
1310 9029 30					

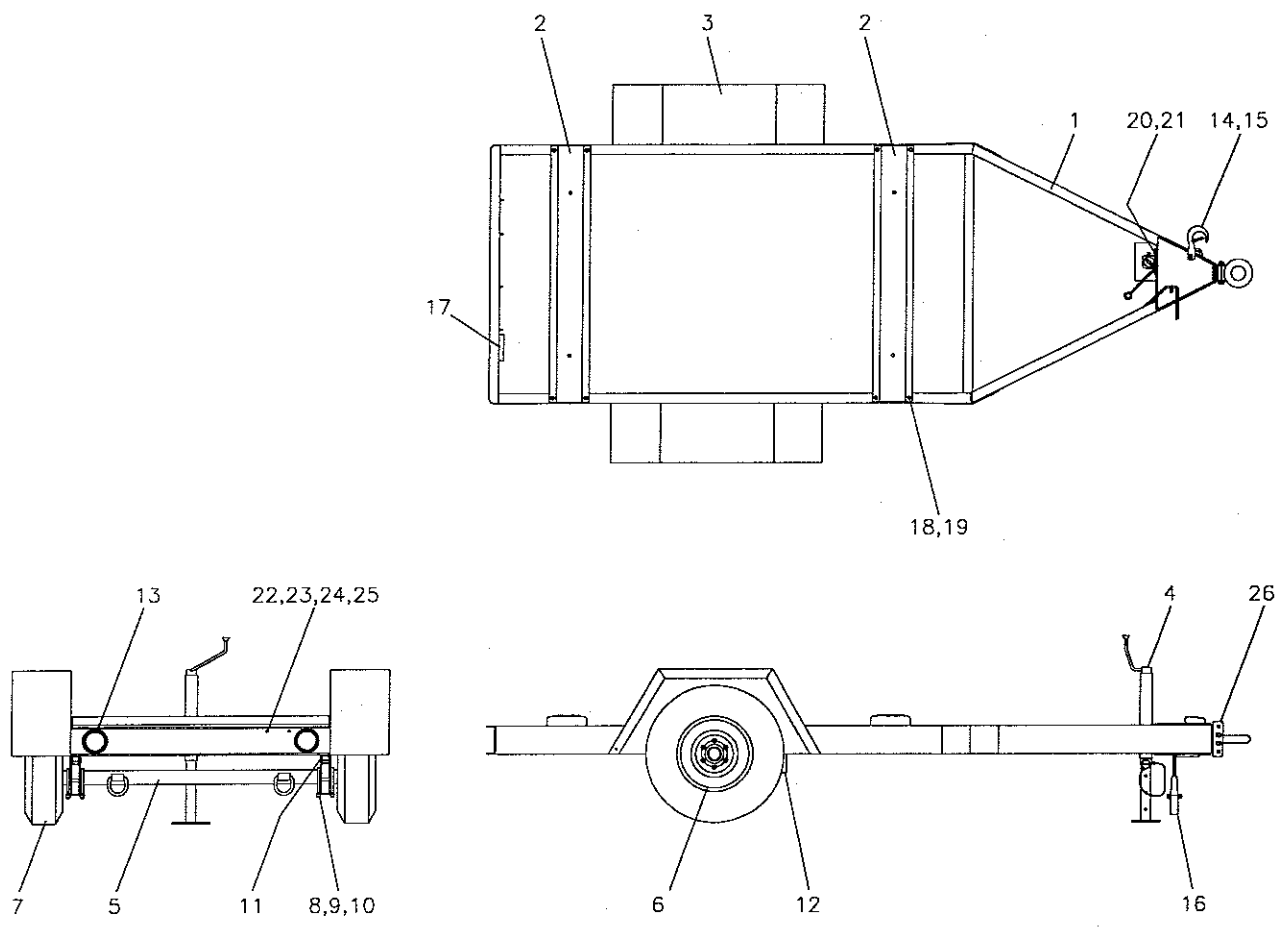

Wheeled Frame Assy. 60KW Single Axle

Ref	Note	Sub	Part No	Description	Qty
1			1310 0332 37	Frame Assembly	1
2			1310 0332 33	Cross Member	2
3			1310 0332 34	Fender	2
4			1310 0332 21	Jack Stand	1
5			1310 0332 36	Axle Beam Assembly	1
6			1310 0322 82	Wheel	2
7			1310 1480 00	Tire 7.00 x 15 LT, 8 Ply	2
8			1310 0314 35	Nut - Shackle * Locknut	6
9			1310 0332 29	Bolt - Shackle	2
10			1310 0314 36	Shackle Link	2
11			1310 0332 43	Hanger - Rear Spring	2
12			1310 0332 23	Hanger - Front Spring	2
13			1310 0332 28	Lamp * Stop, Tail, Turn	2
14			1310 0306 01	Safety Chain	1
15			1310 0332 41	Hook - Clevis Sling	1

Ref	Note	Sub	Part No	Description	Qty
16			1310 0317 23	Plug - Seven Pole	1
17			1310 0332 31	Terminal Block with Cover	1
18			0144 3362 00	Screw 1/2-13 x 1" Lg.	8
19			0333 2238 00	Lockwasher	8
20			0144 3285 03	Screw 3/8-16 x 3/4 Lg.	6
21			0333 2229 00	Lockwasher	6
22			0144 3208 03	Screw 1/4-20 x 1" Lg.	2
23			0268 3204 00	Nut 1/4-20	2
24			0301 2327 00	Flatwasher	2
25			0333 2121 00	Lockwasher	2
26			1310 0332 44	Pintel Eye Assembly	1
Tire/Wheel Assembly P/N 1310 0330 69					
1310 9029 31					

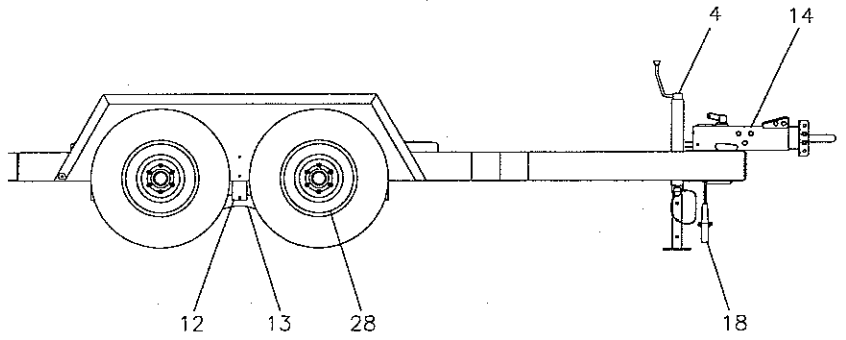
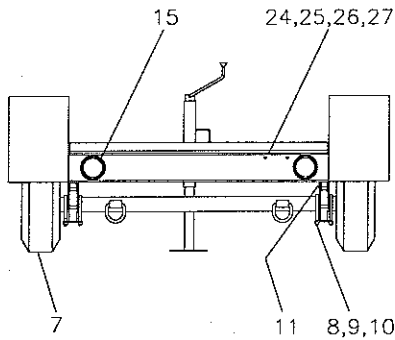
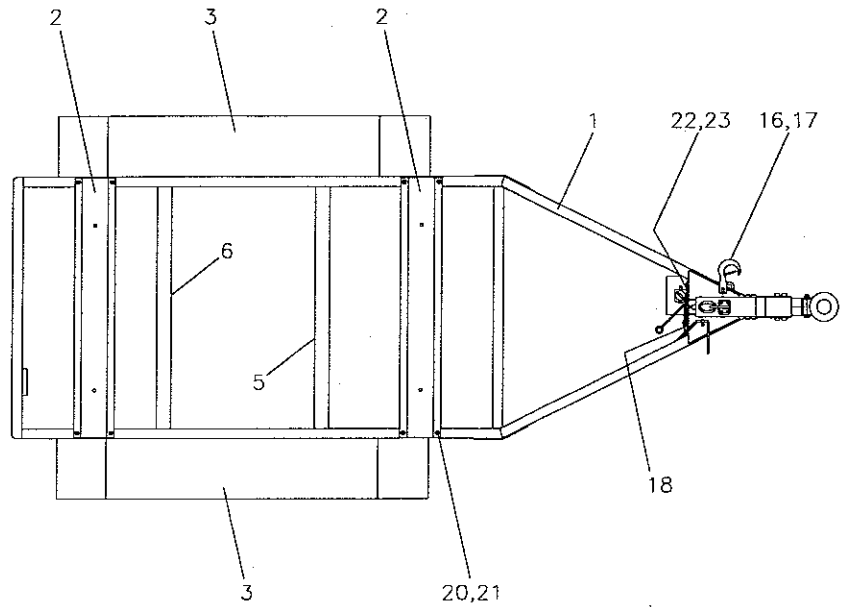

Wheeled Frame Assy. 60KW Tandem Axle

Ref	Note	Sub	Part No	Description	Qty	Ref	Note	Sub	Part No	Description	Qty
1			1310 0332 30	Frame Assembly	1	18			1310 0317 23	Plug - Seven Pole	1
2			1310 0332 33	Cross Member	2	19			1310 0332 31	Terminal Block with Cover	1
3			1310 0332 20	Fender	2	20			0144 3362 00	Screw 1/2-13 x 1" Lg.	8
4			1310 0332 21	Steady Leg	1	21			0333 2238 00	Lockwasher	8
5			1310 0332 35	Axle Beam Assy. with Brake	1	22			0144 3285 03	Screw 3/8-16 x 3/4 Lg.	6
6			1310 0332 36	Axle Beam Assembly	1	23			0333 2229 00	Lockwasher	6
7			1310 1480 00	Tire 7.00x15LT, 8-Ply	4	24			0144 3208 03	Screw 1/4-20 x 1" Lg.	2
8			1310 0314 35	Nut - Shackle * Locknut	14	25			0268 3204 00	Nut 1/4-20	2
9			1310 0332 29	Bolt - Shackle	6	26			0301 2327 00	Flatwasher	2
10			1310 0314 36	Shackle Link	4	27			0333 2121 00	Lockwasher	2
11			1310 0332 23	Hanger - Front and Rear Spring	4	28			1310 0322 82	Wheel	4
12			1310 0332 24	Hanger - Center Spring	2	29			1310 0332 32	Brake Line Kit	1
13			1310 0332 22	Equalizer - Spring	2						
14			1310 0332 25	Hydraulic Brake Actuator	1						
15			1310 0332 28	Lamp * Stop, Tail, Turn	2						
16			1310 0306 01	Safety Chain	1						
17			1310 0332 41	Hook - Clevis Sling	1						
										Tire/Wheel Assembly P/N 1310 0330 69	
										1310 9029 33	

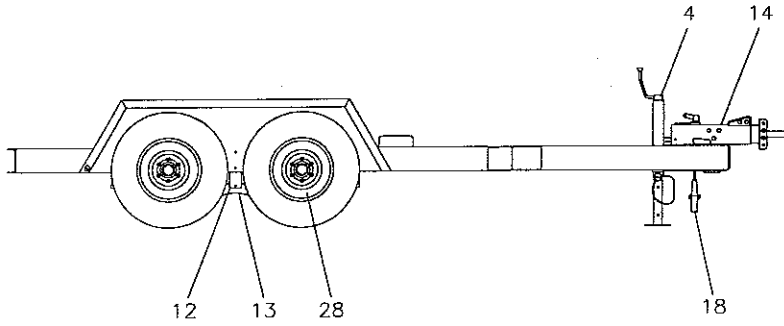
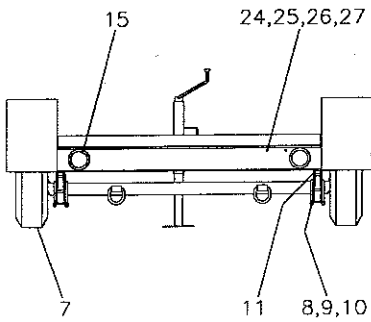
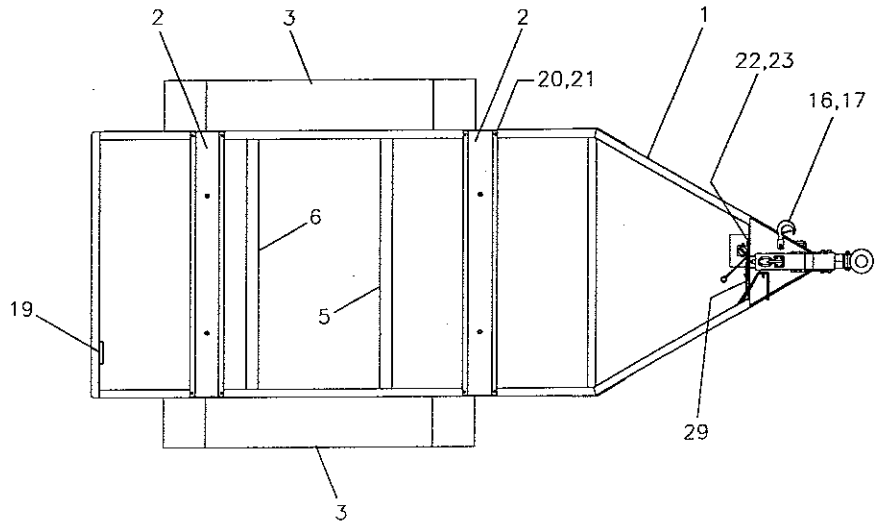

Wheeled Frame Assy. 100KW Tandem Axle

Ref	Note	Sub	Part No	Description	Qty	Ref	Note	Sub	Part No	Description	Qty
1			1310 0332 18	Frame Assembly	1	18			1310 0317 23	Plug - Seven Pole	1
2			1310 0332 19	Cross Member	2	19			1310 0332 31	Terminal Block with Cover	1
3			1310 0332 20	Fender	2	20			0144 3362 00	Screw 1/2-13 x 1" Lg.	8
4			1310 0332 21	Steady Leg	1	21			0333 2238 00	Lockwasher	8
5			1310 0332 27	Axle Beam Assy. with Brake	1	22			0144 3285 03	Screw 3/8-16 x 3/4 Lg.	6
6			1310 0332 26	Axle Beam Assembly	1	23			0333 2229 00	Lockwasher	6
7			1310 1480 00	Tire 7.00x15LT, 8-Ply	4	24			0144 3208 03	Screw 1/4-20 x 1" Lg.	2
8			1310 0314 35	Nut - Shackle * Locknut	14	25			0268 3204 00	Nut 1/4-20	2
9			1310 0332 29	Bolt - Shackle	6	26			0301 2327 00	Flatwasher	2
10			1310 0314 36	Shackle Link	4	27			0333 2121 00	Lockwasher	2
11			1310 0332 23	Hanger - Front and Rear Spring	2	28			1310 0322 81	Wheel	4
12			1310 0332 24	Hanger - Center Spring	2	29			1310 0332 32	Brake Line Kit	1
13			1310 0332 22	Equalizer - Spring	2						
14			1310 0332 25	Hydraulic Brake Actuator	1						
15			1310 0332 28	Lamp * Stop, Tail, Turn	2						
16			1310 0306 01	Safety Chain	1						
17			1310 0332 41	Hook - Clevis Sling	1						
										Tire/Wheel Assembly P/N 1310 0330 69	
										1310 9029 34	

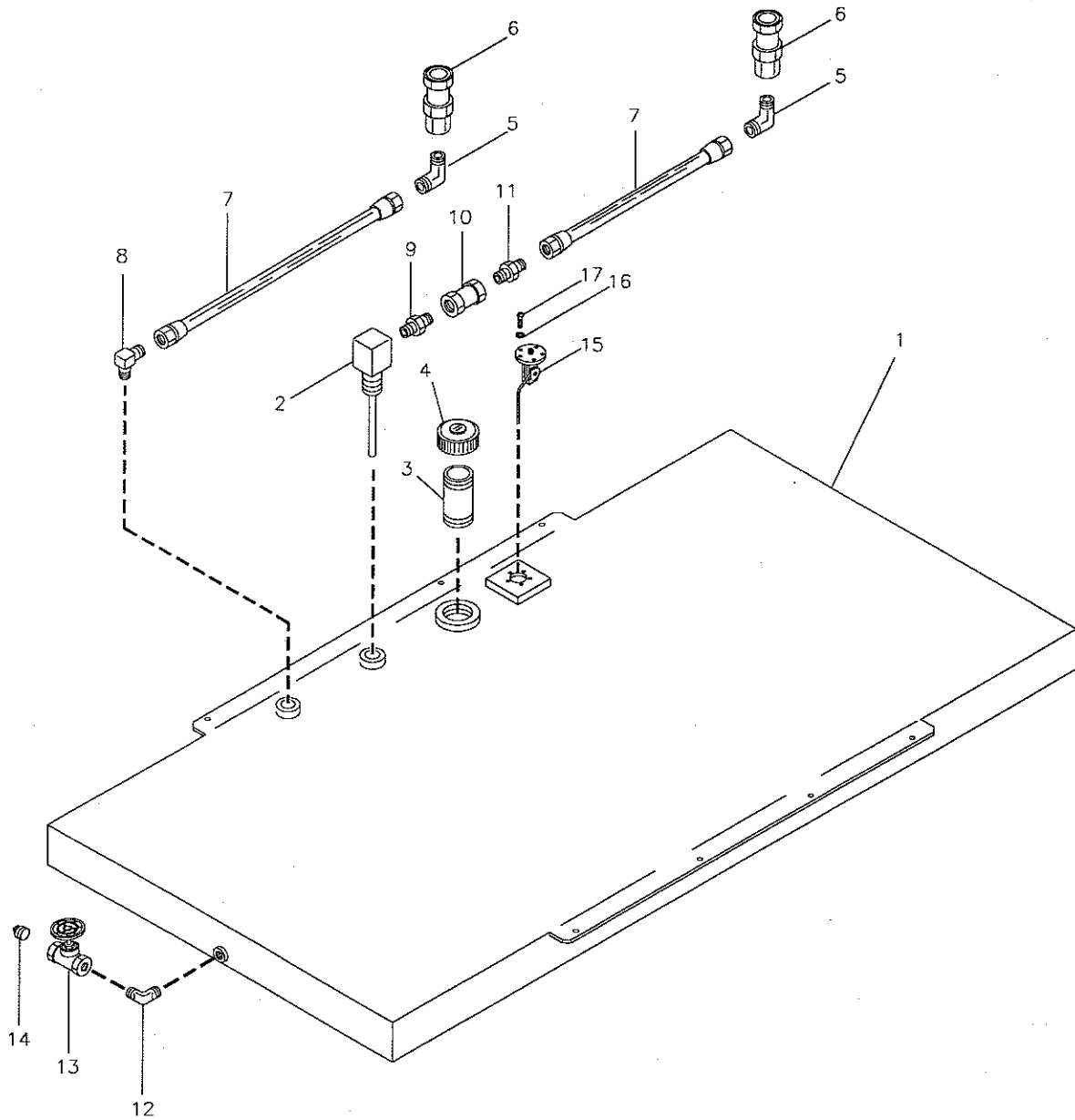

Auxillary Fuel Tank

Ref	Note	Sub	Part No	Description	Qty	Ref	Note	Sub	Part No	Description	Qty
1	1)		1310 0332 45	Fuel Tank (90 Gals.)	1	12			1310 0332 55	Elbow 1/2 NPT Male	1
1	2)		1310 0332 46	Fuel Tank (100 Gals.)	1	13			9710 5321 00	Gate Valve 1/2 NPT	1
1	3)		1310 0332 47	Fuel Tank (160 Gals.)	1	14			1310 0332 56	Plug 1/2 NPT	1
2			1310 0332 48	Drop Tube	1	15			1310 0332 57	Fuel Gauge Sender	1
3			1310 0332 49	Nipple 2' NPT x 5.50 Lg.	1	16			0333 2213 00	Lockwasher	5
4			1310 0332 50	Fuel Cap	1	17			0160 3590 09	Screw #8-32	5
5			1310 0332 51	Elbow 3/8 Tube x 1/4 NPT	2	1)				25KW	
6			1310 0328 06	Bulkhead 3/8 Tube x 1/4 NPT	2	2)				35, 60 KW	
7			1310 0332 52	Hose Assy.	2	3)				100, 125, 150, 175, 200 KW	
8			1310 0327 17	Elbow 1/4 NPT, 45 Deg. Flare	1						
9			1310 0332 53	Nipple - Hex 1/4 NPT	1						
10			1310 0332 54	Check Valve 1/4 NPT	1						
11			1310 0327 08	Coupling * 3/8 ODT x 1/4 NPT	1						
											1310 9029 35