

3.0 L
INDUSTRIAL GASOLINE ENGINE

Owner/ Operators Manual

A GM Powertrain Product
by Great Lakes Power Center, Inc.
Wood Dale, IL

A Subsidiary of Power Great Lakes, Inc. TM



Handwritten text, possibly a title or header, located in the upper middle section of the page.

Handwritten text, possibly a date or a specific reference, located in the middle section of the page.

Handwritten text, possibly a signature or a name, located in the lower left section of the page.

Handwritten text, possibly a date or a specific reference, located in the lower middle section of the page.

To the Operator

Power - driven equipment is only as safe as the person operating the controls. You are urged as the operator of this diesel engine, to keep fingers and clothing away from the revolving belts, drive shafts, etc. on the engine installation.

This guide contains instructions on the safe operation and preventative maintenance of your GM Powertrain Industrial Engine.. Maintenance instructions cover routine services such as lube oil and filter changes in enough detail to permit self-servicing, if desired.

The operator should become familiar with the contents of this manual before operating the engine or carrying our maintenance procedures.

Throughout this guide, cautions regarding personal safety will be marked by the symbol to the left. Notices regarding engine performance or service life will also appear marked by "Attention". To avoid personal injury and ensure long engine service life, always read these instructions.

Whenever possible, it will benefit you to rely on an authorized Great Lakes Power Center service outlet for all your service needs from maintenance to major parts replacement. Authorized service outlets worldwide stock factory original parts and have the specialized equipment and experienced, trained personnel to provide prompt preventive maintenance and skilled engine repairs.

The information and specifications in this publication are based on the information in effect at the time of approval from printing. Contact an authorized Great Lakes Power Center service outlet for information on the latest revision. The right is reserved to make changes at any time without obligation.

**Great Lakes Power Center, Inc.
Industrial Gasoline Engines**

Industrial gasoline engines are manufactured for Great Lakes Power Center, Inc. by GM Powertrain, a division of General Motors Corp. The engines are sold and supported throughout the United States and Canada by Power Great Lakes, Inc. (PGL, Inc.) and a Power Great Lakes, Inc. Distributor and Dealer organization.

For this reason all references in this manual to GM POWERTRAIN engines shall be read to mean Great Lakes Power Center, Inc. A subsidiary of Power Great Lakes, Inc., or Power Great Lakes, Inc.

Additional copies of this manual may be purchased from PGL, Inc. or any of its authorized Distributors or Dealers throughout North America.

For further information about all Great Lakes Power Center and Power Great Lakes, Inc. products please contact:

**Heidi Schaaf
Power Great Lakes, Inc.
655 Wheat Lane
Wood Dale, IL 60102
800-551-2938
708-350-9400**

OPERATING INSTRUCTIONS

GM Powertrain

INDUSTRIAL ENGINES

The PGL, Inc. gasoline engine is equipped with an electronic governor for speed control and engine regulation. You will note the absence of a throttle cable. The engine speeds are preset at the factory and should require NO adjustment of the engine speeds in the field.

Engine Controls and Instruments:

The engine power unit is equipped with an instrument panel containing Murphy Safety Gauges. Located in this panel are the key switch, two (2) toggle switches, and the engine choke cable.

The panel also contains a shut down relay, volt meter, low oil pressure gauge, high water temperature gauge, and tach/hour meter.

Control Switches:

Looking at the instrument panel, there are two (2) toggle switches at the bottom of the panel. The switch on the left, is the governor On/Off switch. The switch on the right, is the governor speed control Hi/Lo switch.

Choke Cable:

Note the location of the engine Choke Cable. It will either be in the instrument panel near the toggle switches, or just below the instrument panel, mounted in the sheet metal.

Starting the Engine:

Pull the choke cable to the full on position.

With the On/Off toggle switch in the On position, and the Hi/Lo switch in the Middle position, turn the key switch to the start position and begin cranking the engine, pushing in the Murphy shut down relay button. After the engine starts and oil pressure increases, release the relay button, and gradually begin pushing in on the choke cable.

Note: On cold days it may be necessary to use the engine choke longer than it will be on warm days. Do Not over choke the engine as this will cause flooding, and difficulty in starting the engine.

Allow the engine to warm up a few minutes at this RPM.

Engaging the Clutch:

If your engine is equipped with a PTO type clutch, the following will be of interest to you.

Move the Hi/Lo switch to the Lo position. The engine speed will now increase to 1100 ± 50 RPM. At this RPM the engine clutch can now be engaged.

Preferred engagement of the clutch is with one single hand lever movement. However, a machine that has a sizable driven inertia load may require 'bumping in' the clutch. These types of machines generally have a resistance to start-up rotation and a tendency to stall the engine. It may take two, three or four seconds to bring the load up to the engine speed. 'Bumping in' involves several partial engagements with the hand lever. Each synchronized motion promotes rotation to the driven mass, progressively increasing speed. After two or three 'bumps' the hand lever is moved to the fully engaged position

NOTE:

The 'bumping in' procedure may be necessary, when the engine is first started in the morning, or in Winter weather.

Operator experience often dictates the number of 'bumps' required for a specific machine to allow the engine to accelerate the mass.

(If the engine stalls during engagement of the clutch, return the Hi/Lo switch to the middle position, push in on the Murphy relay button, and restart the engine.)

Move the Hi/Lo switch to the Lo position and engage the clutch. As the driven load increases in speed, you will note that the engine RPM may cycle ± 100 RPM for a few seconds before it again stabilizes. This results from the inertia of the driven load driving the engine RPM above and below the governed speed until the governor can control the speed.

Move the Hi/Lo switch to the Hi position. The engine will begin to increase in speed to the preset max RPM specified by the OEM. Again you will note that the engine will cycle ± 200 to 300 RPM because of driven load inertia, but will become steady within a few minutes.

Commence Operation:

Work Cycle Complete:

When work cycle has been completed, return the Hi/Lo switch to the Middle position, and disengage the clutch.

The engine speed will now return to approximately 800 to 1000 RPM.

Engine Cool Down:

Allow the engine to run at this RPM for a few minutes, to cool the engine down.

Move the On/Off switch to the Off position, and allow the engine to return to slow idle (500 to 600 RPM).

Then turn the Key Switch to the off position.

CAUTION:

THE GOVERNOR CONTROLLER IS PRESET AT THE FACTORY AND MUST NOT BE TAMPERED WITH. IF FOR ANY REASON YOU DO NOT FEEL THAT THE GOVERNOR IS FUNCTIONING PROPERLY PLEASE CALL POWER GREAT LAKES, INC. IMMEDIATELY, AT 800 551 2938, ASK FOR DICK BEIL OR BOB TRUMP.

UNDER NO CIRCUMSTANCES SHOULD ANY UNAUTHORIZED PERSON ATTEMPT TO MAKE ANY ADJUSTMENTS TO THE GOVERNOR CONTROLLER.

Great Lakes Power Center
655 Wheat Lane
Wood Dale, IL 60191

WARRANTY

WARRANTY ON NEW GENERAL MOTORS POWERTRAIN (GMPT) ENGINES IN ORIGINAL EQUIPMENT MANUFACTURERS (OEM) INDUSTRIAL POWER APPLICATIONS

GMPT warrants to the OEM only, each new engine manufactured or supplied by GMPT and sold to the OEM for installation in its industrial application, that for a period of 12 months or 1,500 hours, whichever first occurs, it will reimburse or credit OEM for necessary repairs or replacements of any defective or malfunctioning parts of such engine up to the original price of the engine and up to a maximum of four (4) hours labor.

The Warranty period shall begin on the date the OEM industrial equipment is delivered to the first retail purchaser or if the irrigation equipment is first placed in service prior to sale at retail, it will be the date the equipment is first placed in such service.

This Warranty covers only malfunctions resulting from defects in material or workmanship.

This Warranty does not cover malfunctions resulting from misuse, negligence, accident, alterations not approved by GMPT, lack of performance of normal maintenance services or improper installation: the replacement of maintenance items (such as spark plugs, ignition points, positive crankcase ventilator valve, and filters) made in connection with normal maintenance service: loss of time, inconvenience, loss of use of the equipment or other consequential damages: or labor for removal from or reinstallation of the component in the industrial equipment.

GMPT will reimburse or credit the OEM for the repair or replacement under this Warranty for any part found to be defective or the cause of a malfunction. Such reimbursement or credit will be at GMPT's current price of such part to the OEM and bench repair labor.

Defective or malfunctioning parts qualifying under this Warranty must be held at the OEM's place of business for examination by GMPT.

This Warranty is the only Warranty applicable to engines and is expressly in lieu of any other warranties, expressed or implied, including any implied Warranty of merchantability or fitness for a particular purpose, and or any other obligation or liability on the part of GMPT: and GMPT neither assumes nor authorizes any other person to assume for it any other liability in connection with such engines.

Safety Precautions

These safety precautions are important. You must refer also to the local regulations in the country of use. Some items only apply to specific applications.

- * Only use these engines in the type of application for which they have been designed.
- * Do not change the specification of the engine.
- * Do not smoke when you put fuel in the tank.
- * Clean away fuel which has been spilt. Material which has been contaminated by fuel must be moved to a safe place.
- * Do not put fuel in the tank while the engine runs (unless it is absolutely necessary).
- * Do not clean, add lubricating oil, or adjust the engine while it runs (unless you have had the correct training; even then extreme caution must be used to prevent injury).
- * Do not make adjustments that you do not understand.
- * Ensure that the engine does not run in a location where it can cause a concentration of toxic emissions.
- * Other persons must be kept at a safe distance while the engine or equipment is in operation.
- * Do not permit loose clothing or long hair near moving parts.
- * Keep away from moving part during engine operation. **ATTENTION:** The fan cannot be seen clearly while the engine runs.
- * Do not operate the engine if a safety guard has been removed.
- * Do not remove the filler cap of the cooling system while the engine is hot and while the coolant is under pressure, because dangerous hot coolant can be discharged.
- * Do not use salt water or any other coolant which can cause corrosion in the closed cooling circuit.
- * Do not allow sparks or fire near the batteries (especially when the batteries are on charge) because the gases from the electrolyte are highly flammable. The battery fluid is dangerous to the skin and especially to the eyes.
- * Disconnect the battery terminals before a repair is made to the electrical system.
- * If your skin comes into contact with high-pressure fuel, obtain medical assistance immediately.
- * Gasoline and lubricating oil (especially used lubricating oil) can damage the skin of certain persons. Protect your hands with gloves or a special solution to protect the skin.
- * Do not wear clothing which is contaminated by lubricating oil. Do not put material which is contaminated with oil into the pockets.
- * Discard used lubricating oil in a safe place to prevent contamination.
- * Do not move mobile equipment if the brakes are not in good condition.
- * Ensure that the control lever of the transmission drive is in the "out-of-drive" position before the engine is started.
- * The combustible material of some components of the engine (for example certain seals) can become extremely dangerous if it is burned. Never allow this burnt material to come into contact with the skin or with the eyes.
- * Fit only genuine GM Powertrain or Power Great Lakes Parts.

Gasoline Requirements

The ignition timing set by the factory requires the use of lead-free gasoline with the following minimum or higher octane rating:

Anti-Knock Index Number (AKI) - 87
Research Octane Number (RON) - 91

NOTE: Use of gasoline with a lower than 87 AKI (91 RON) octane will result in serious damage to your engine.

Engine damage resulting from the use of lower octane gasoline than 87 AKI (91 RON) is considered misuse of the engine and will void your engine warranty.

Detonation or spark knock in an engine is not necessarily audible. Overheating and continued running after the ignition switch is turned off are indications of detonation in the engine. If you suspect detonation or spark knock, contact your distributor/dealer.

SAFETY WARNING

GASOLINE IS EXTREMELY FLAMMABLE AND HIGHLY EXPOSIVE UNDER CERTAIN CONDITIONS. ALWAYS STOP THE ENGINE AND DO NOT SMOKE, OR ALLOW OTHERS TO SMOKE, OR ALLOW OPEN FLAMES OR SPARKS NEAR THE FUEL TANK OR ENGINE WHEN REFUELING.

GASOLINE CONTAINING ALCOHOL

Many gasolines being sold today contain alcohol. Two commonly used alcohol additives are Ethanol (ethyl alcohol) and Methanol (methyl alcohol).

Your gasoline engine may be operated using gasolines blended with no more than 10% Ethanol meeting the minimum octane

specifications. **DO NOT** use any gasoline which contains **METHANOL**.

SAFETY WARNING

FUEL LEAKAGE CAN CONTRIBUTE TO A FIRE AND/OR AN EXPLOSION.

MOTOR OIL

To obtain the best engine performance and life, use only motor oils with the recommended quality and viscosity. Motor oils are specified by API service, letter designations and SAE viscosity numbers.

Initial factory fill is a high quality oil for API Service SF/CC. During the initial break in period, frequently check the oil level. Somewhat higher than normal oil consumption may occur during the first 20 hours of use. If it is necessary to add any oil, use a premium quality single viscosity motor oil with API Service designation SF/CC.

When you add or change motor oil, use only oils with API Service SF and select from the following chart the SAE viscosity that matches the temperature range in which you expect to operate. If necessary to add oil, use a premium quality oil API Service SG/CD, SF/CC of the same viscosity.

Recommended SAE Viscosity Grades.

5W20	+20 to -25 Degrees 'F'
10W30	+104 to -15 Degrees 'F'
15W40	+122 to +14 Degrees 'F'
20W50	+122 to +25 Degrees 'F'
10W	+40 to -25 Degrees 'F'
20W	+75 to +32 Degrees 'F'
30W	+104 to +45 Degrees 'F'
40W	+122 to +60 Degrees 'F'

GENERAL INFORMATION

SAFETY

This manual contain certain information related to the personal safety of the operator and/or bystanders.

THE SAFETY SYMBOL , APPEARS NEXT TO IMPORTANT INFORMATION TO PREVENT YOU AND OTHERS FROM BEING HURT.

Please observe all safety warnings contained in this manual.

PRODUCT REFERENCES

When reference is made in this manual to a brand name, number, or product, and equivalent product may be used in place of the product referred to unless specifically stated otherwise.

SPECIFICATIONS

Great Lakes Power Center, Inc. and Power Great Lakes, Inc. reserves the right to make changes at any time, without notice, to specifications and models and also discontinue models. The right is also reserved to change specifications or parts at any time without incurring any obligation to equip same on models manufactured prior to the date of change.

ENGINE IDENTIFICATION

The initial gasoline engines provided by Great Lakes Power Center are of four cylinder in-line, V-six, and V-eight configuration. The engines are spark ignited, and can be provided in gasoline, liquid propane gas, natural gas, and compressed natural gas configuration.

SERIAL NUMBER

The engines are identified by stamping an engine serial number into the cylinder block, and with a metalized serial number tag affixed to the engine rocker cover.

On four cylinder engines, the serial number is stamped into the cylinder block on the right side of the engine, just in front of the flywheel housing. On 'V' configured engines the number is stamped into the cylinder block on the left side of the engine just in front of the flywheel housing.

The metalized tag contains the engine model number as well as the serialized number.

EXAMPLE:

3.OLA.....Engine Displacement in Liters.

'A'.....Year of Manufacture
(I.E. 'A' 1996
'B' 1997
'C' 1998
'D' 1999
'E' 2000

The following digits being the engine serial number.

If you need parts, service, or information for your engine, you must provide the complete engine serial number to your Power Great Lakes, Inc. distributor/dealer.

GM 3.0L Parts List

Part Number	Qty	Description	Engine Group
89671K	1	2 1/2" Pipe, Cut 9"	Air Filtration
G06-5411	1	Cleaner, Air	Air Filtration
H00-1378	1	Hood, Inlet	Air Filtration
H00-8444	1	Band, Mounting	Air Filtration
P10-5531	2	Elbow	Air Filtration
S-44	4	Clamp, Hose	Air Filtration

101025	1	Radiator	Cooling
101029	1	Spacer, Fan	Cooling
101074	1	Belt, Fan	Cooling
101075	1	Hose, Upper	Cooling
101076	1	Hose, Lower	Cooling
101089	1	Fan, Suction	Cooling
101115	1	Radiator Stay Bar RHS	Cooling
101116	1	Radiator Stay Bar LHS	Cooling
2431134	1	Thermometer, Plug	Cooling
S-20	2	Clamp, Hose	Cooling
S-28	2	Clamp, Hose	Cooling
TPC62372	2	Isolator	Cooling

101004	1	Pulley, Alternator	Electric's
101013	1	Starter	Electric's
101030	1	Alternator Spacer	Electric's
101073	1	Bolt, Starter	Electric's
101082	1	Brace, Alternator	Electric's
800612	1	Fan, Alternator	Electric's
1101228	1	Alternator	Electric's

101011	1	Mount, Front	Engine Mounting
101012	2	Mount, Rear	Engine Mounting

101005	1	Pulley, Fan	Engine Trim
101028	1	Label, Serial Number	Engine Trim
101049	1	Bracket, Alternator	Engine Trim
101050	1	Filter, Oil	Engine Trim
101051	1	Grommet	Engine Trim
101060	1	Spacer, Alternator	Engine Trim
101061	1	Elbow	Engine Trim
101094	1	Breather, Cap	Engine Trim
101095	1	Grommet	Engine Trim
101098	1	3/8 Cap	Engine Trim
101131B	1	Pulley, PTO	Engine Trim
SK-10040A	1	Skid	Engine Trim

101121	1	Exhaust "J" Pipe & Flange	Exhaust
101122	1	Exhaust Extension Pipe	Exhaust
101135	1	Muffler	Exhaust
101136	1	Exhaust Clamp	Exhaust
101137	1	Exhaust Elbow	Exhaust
101138	1	Rain Cap	Exhaust
89541K	3	2" Muffler Clamp	Exhaust
TPC51308	2	Isolator	Exhaust

GM 3.0L Parts List

Part Number	Qty	Description	Engine Group
101021	1	Filter, Fuel (loose)	Fuel
101022	1	Carburetor	Fuel
101023	1	Pump, Fuel (loose)	Fuel
101035	2	Gasket, Carb.	Fuel
101047	1	Cover, Fuel Pump	Fuel
101048	1	Gasket, Fuel Pump	Fuel
101088	1	Horn, Air	Fuel
101093	1	Fitting, Carb	Fuel
101099	1	Choke Cable	Fuel
101145	1	Gasket, Carb.	Fuel
S-10	1	Clamp, Hose	Fuel

101108	1	Actuator, Governor	Governor
101109	1	Controller, Governor	Governor
K101160	1	Linkage, Governor	Governor
101129	1	Bracket, Actuator	Governor

101010	1	Plate, Cover	Housing/Flywheel
101016	1	Bearing Carrier	Housing/Flywheel
101020	1	Flywheel	Housing/Flywheel
101066	1	Housing, Flywheel	Housing/Flywheel

3849	1	Oil Pressure Kit	Instrumentation
35327	1	Key Switch	Instrumentation
101024	1	Lead, Power	Instrumentation
101091	1	Switch	Instrumentation
101092	2	Seal/Boot	Instrumentation
101111	1	Switch	Instrumentation
101112	1	Hi-Low Plate	Instrumentation
101143	1	Harness, Wire	Instrumentation
105142	1	Tachometer	Instrumentation
30090250	1	Panel, Instrument	Instrumentation
31812163	1	Caution Plate	Instrumentation

101101	2	Bracket, Rear Mount	Sheet Metal Enclosure
101102	2	Bracket, Front Mount	Sheet Metal Enclosure
12-11014-12	1	Retainer	Sheet Metal Enclosure
12-11017-11	1	Receptacle	Sheet Metal Enclosure
12-13-203-11	1	Knurl Screw	Sheet Metal Enclosure
97-60-324-11	4	Draw Latch	Sheet Metal Enclosure
BPF3	2	Plug	Sheet Metal Enclosure
BPF3/8	6	Plug	Sheet Metal Enclosure
SM0004	2	Outer Support Brkt. Rear	Sheet Metal Enclosure
SM0012	1	Front Panel	Sheet Metal Enclosure
SM0013	1	Rear Panel	Sheet Metal Enclosure
SM0014	2	Side Filler Panel	Sheet Metal Enclosure
SM0015	2	Door	Sheet Metal Enclosure
SM0016	1	Hood	Sheet Metal Enclosure
TPC51308	4	Isolator	Sheet Metal Enclosure

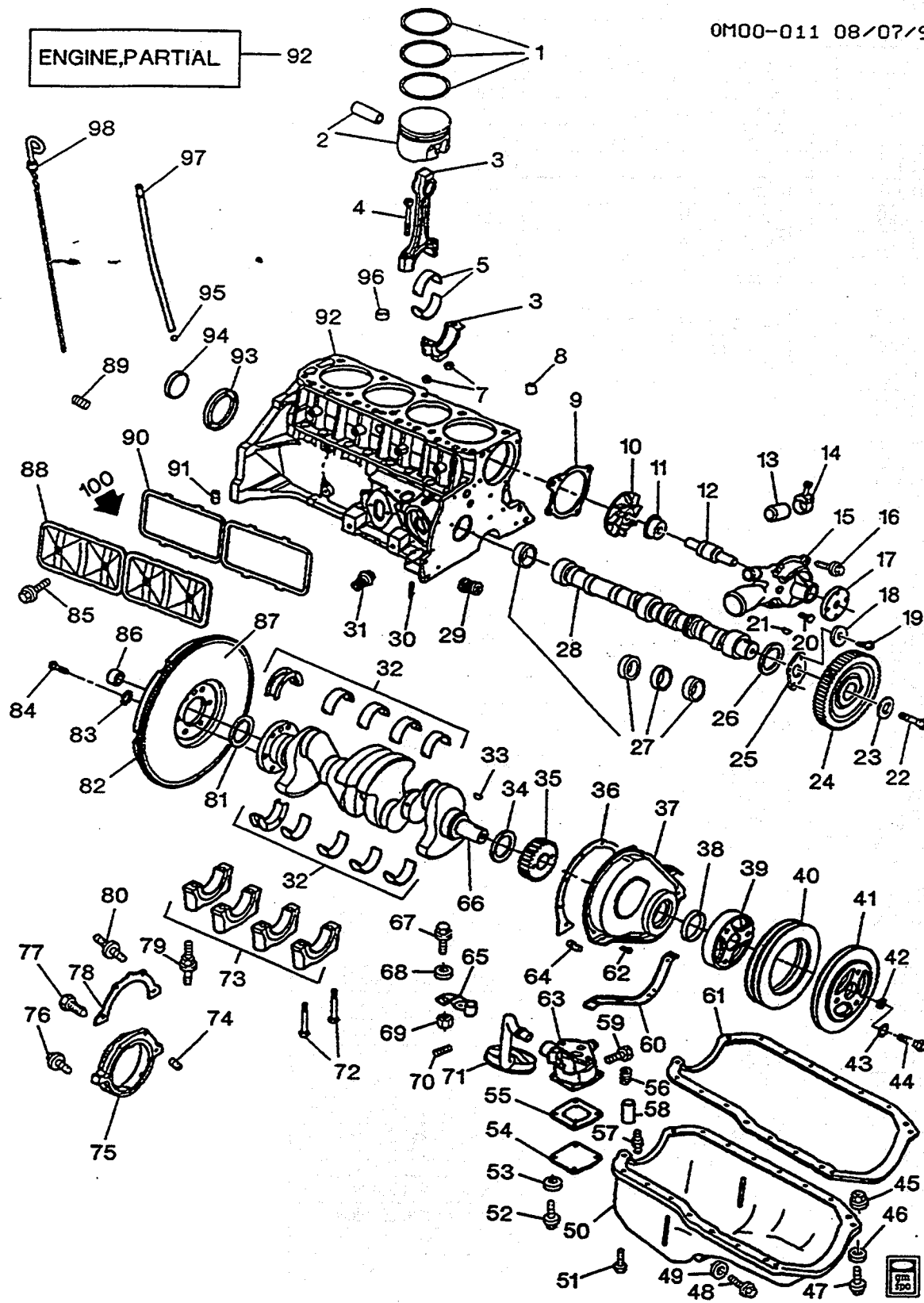

OM00-011D

1991-1996 OEM ENGINE ASM-3.0L L4 PART 1

1.	0.643	RING KIT, PSTN (STD) (FOR PISTONS W/DEEP OIL GROOVE)	91-93 (LW6)	4	14089025
	0.643	RING KIT, PSTN (.030 O.S.)	91-93 (LW6)	4	14089026
	0.643	RING KIT, PSTN (.020 OVSI - *14, 25)	95 (LW6)	1	12361570

	0.643	RING KIT, PSTN (.020 OVSI - *2, 14, 25)	96 I (LW6)	1	12361570
	0.643	RING KIT, PSTN (.020 OVSI - *23, 25)	94 I (LW6)	1	12361570
	0.643	RING KIT, PSTN (*19, 20, 21, 22, 23, 24, 27) (STD) (FOR PISTONS W/DEEP OIL GROOVE)	94-96 I (LW6)	4	14089025
	0.643	RING KIT, PSTN (*19, 20, 21, 22, 23, 24, 27) (.030 O.S.)	94-96 I (LW6)	4	14089025
	0.643	RING KIT, PSTN (*2, 14, 25) (STD) (FOR PISTONS W/DEEP OIL GROOVE)	94-96 I (LW6)	4	14089025
2.	0.629	PISTON, (W/PIN) (.020 OVSI - *14, 25)	95 I (LW6)	4	3937768
	0.629	PISTON, (W/PIN) (.020 OVSI - *2, 14, 25)	96 I (LW6)	4	3937768
	0.629	PISTON, (W/PIN) (.020 OVSI - *23, 25)	94 I (LW6)	4	3937768
	0.629	PISTON, (W/PIN) (.020" O.S. - *1, 2, 4, 7, 9, 10, 11, 12, 13, 15, 19, 20, 21, 22)	91-94 I (LW6)	4	93419821
	0.629	PISTON, (W/PIN) (.020" O.S. - *19, 20, 21, 22, 27)	95-96 I (LW6)	4	93419821
	0.629	PISTON, (W/PIN) (HI-LIMIT - *1, 2, 4, 7, 9, 10, 11, 12, 13, 15, 19, 20, 21, 22)	91-94 I (LW6)	4	93419820
	0.629	PISTON, (W/PIN) (HI-LIMIT - *19, 20, 21, 22, 27)	95-96 I (LW6)	4	93419820
	0.629	PISTON, (W/PIN) (STD - *1, 2, 4, 7, 9, 10, 11, 12, 13, 15, 19, 20, 21, 22)	91-94 I (LW6)	4	93419819
	0.629	PISTON, (W/PIN) (STD - *19, 20, 21, 22, 27)	95-96 I (LW6)	4	93419819
	0.629	PISTON, (W/PIN) (STD - *2, 14, 25)	96 I (LW6)	4	3963663
	0.629	PISTON, (W/PIN) (STD - *3, 5, 6, 8, 14, 16, 23, 25)	91-95 I (LW6)	4	3963663
	0.629	PISTON, (W/PIN) (STD HI LIMIT - *2, 14, 25)	95-96 I (LW6)	4	3963667
	0.629	PISTON, (W/PIN) (STD HI LIMIT - *23, 25)	94 I (LW6)	4	3963667
3.	0.603	ROD, CONN (*14) (INCL 4, 6, 7)	91-92 I (LW6)	4	93423947
	0.603	ROD, CONN (*14) (INCL 4, 6, 7)	95-96 I (LW6)	4	93423947
	0.603	ROD, CONN (*19, 20, 21, 22, 24, 25, 27) (INCL 4, 6, 7)	94-96 I (LW6)	4	93423947
	0.603	ROD, CONN (*4, 6, 7) (INCL 4, 6, 7)	91-93 I (LW6)	4	93423947
4.	0.623	BOLT, CONN ROD (PART OF 3)	91-93 I (LW6)	8	14050532
	0.623	BOLT, CONN ROD (*19, 20, 21, 22, 23, 24, 25, 27) (PART OF 3) (3/8-24X1 59/64)	94-95 I (LW6)	8	461372
	0.623	BOLT, CONN ROD (*2, 14, 19, 20, 21, 22, 26, 27) (PART OF 3) (3/8-24X1 59/64)	96 I (LW6)	8	461372
5.	0.616	BEARING KIT, CONN ROD (.001 U.S.)	91-93 I (LW6)	4	12523925
	0.616	BEARING KIT, CONN ROD (.001 U.S.) (*19, 20, 21, 22, 23, 24, 25, 26, 27)	94 I (LW6)	4	12523925

	0.616	BEARING KIT, CONN ROD (.001 U.S.) (*2, 14, 19, 20, 21, 22, 25, 26, 27)	95-96 I (LW6)	4	12523925
	0.616	BEARING KIT, CONN ROD (STD)	91-93 I (LW6)	4	12523924
	0.616	BEARING KIT, CONN ROD (STD) (*19, 20, 21, 22, 23, 24, 25, 26, 27)	94 I (LW6)	4	12523924
	0.616	BEARING KIT, CONN ROD (STD) (*2, 14, 19, 20, 21, 22, 25, 26, 27)	95-96 I (LW6)	4	12523924
7.	0.626	NUT, CONN ROD (PART OF 3) (3/8-24, 301M ZC) (HEX) (8.915)	91-95 I (LW6)	8	225854
	0.626	NUT, CONN ROD (*2, 14, 19, 20, 21, 22, 25, 26, 27) (PART OF 3) (3/8-24, 301M ZC) (HEX) (8.915)	96 I (LW6)	8	225854
8.	1.639	BEARING, O/PMP DRV SHF (2.375)	91-96 I (LW6)	1	326312
9.	1.079	GASKET, W/PMP (1.069)	91-96 I (LW6)	1	10101256
10.	N.S.	IMPELLER, W/PMP (PART OF 15)			
11.	N.S.	SEAL, W/PMP BRG (PART OF 15)			
12.	N.S.	BEARING, W/PMP (PART OF 15)			
13.	8.846	CAP, HTR WAT OTLT (*2, 14, 25, 26, 27) (1.073) (AC-DELCO #15544596)	95-96 I (LW6)	1	15544596
	8.846	CAP, HTR WAT OTLT (*23, 24, 25, 26, 27) (1.073) (AC-DELCO #15544596)	94 I (LW6)	1	15544596
	8.846	CAP, HTR WAT OTLT (*3, 5, 8, 14, 16) (1.073) (AC-DELCO #15544596)	91-93 I (LW6)	1	15544596
14.	8.948	CLAMP, WORM TYPE (11/16" TO 1 5/16") (HTR WAT OTLT CAP) (*3, 5, 8, 14, 16)	91-93 I (LW6)	AR	1470030
	8.948	CLAMP, WORM TYPE (11/16" TO 1 5/16") (HTR WAT OTLT CAP) (*23, 24, 25)	94 I (LW6)	AR	1470030
	8.948	CLAMP, WORM TYPE (11/16" TO 1 5/16") (HTR WAT OTLT CAP) (*14, 25, 26, 27)	95 I (LW6)	AR	1470030
	8.948	CLAMP, WORM TYPE (11/16" TO 1 5/16") (HTR WAT OTLT CAP) (*2, 14, 25, 26, 27)	96 I (LW6)	AR	1470030
15.	1.069	PUMP, WAT (*2)	96 I (LW6)	1	12528816
	1.069	PUMP, WAT (COOLANT) (INCL 10, 11, 12, 17) (*3, 5, 6, 8, 14, 16)	91-93 I (LW6)	1	10120938
	1.069	PUMP KIT, WAT (*1, 2, 4, 7, 9, 10, 11, 12, 13, 15)	91-93 I (LW6)	1	10174859
	1.069	PUMP KIT, WAT (*14, 25, 26, 27)	95-96 I (LW6)	1	12523504
	1.069	PUMP KIT, WAT (*19, 20, 21, 22)	94-96 I (LW6)	1	12523503
	1.069	PUMP KIT, WAT (*23, 24, 25, 26, 27)	94 I (LW6)	1	12523504
16.	1.079	BOLT, W/PMP (5/16-18 X 7/8) (CAD/ZC) (8.900)	91-96 I (LW6)		443899
17.	N.S.	HUB, FAN & W/PMP PUL (PART OF 15)	91-96 I (LW6)		
18.	8.932	WASHER, LOCK-1/4 EXT TOOTH ZN (CM/SHF THR BRG) (AC-DELCO #121753)	91-96 I (LW6)		121753

19.	0.533	BOLT, CM/SHF THR BRG (1/4-20X1/2) (HEX HD) (8.900) (AC-DELCO #9442008)	91-96 I (LW6)	1	9442008
20.	1.079	BOLT, W/PMP (HEX, 5/16-18X1.50) (8.900) (AC-DELCO #9440366)	91-96 I (LW6)	2	9440366
21.	0.738	KEY, CM/SHF GR (PART OF 28) (#9 .187X.750 PL) (8.960)	91-96 I (LW6)	2	106751
22.	0.738	BOLT, CM/SHF SPKT (1.060) ...	91-93 I (LW6)	AR	25534251
	0.738	BOLT, CM/SHF SPKT (*4, 12, 24, 25) (1/4-20X1/2) (HEX HD) (8.900) (AC-DELCO #9442008)	94-96 I (LW6)	2	9442008
23.	0.738	WASHER, CM/SHF SPKT (0.659)	91-93 I (LW6)	1	10101744
24.	0.736	GEAR, CM/SHF	91-96 I (LW6)	1	2771369
25.	0.533	PLATE KIT, CM/SHF THR (INCL 26)	91-96 I (LW6)	1	12508079
26.	0.738	RING, CM/SHF SPKT SPCR	91-96 I (LW6)	1	549631
27.	0.539	BEARING, CM/SHF	91-96 I (LW6)	3	14002525
28.	0.519	CAMSHAFT, ENG (*1, 2, 4, 7, 9, 10, 11, 12, 13, 15) (INCL 21, 26)	91-93 I (LW6)	1	3937764
	0.519	CAMSHAFT, ENG (*19, 20, 21, 22) (INCL 21, 26)	94-96 I (LW6)	1	3937764
	0.519	CAMSHAFT, ENG (*2, 14, 25, 26, 27) (INCL 21, 26)	95-96 I (LW6)	1	2770015
	0.519	CAMSHAFT, ENG (*23, 24, 25, 26, 27) (INCL 21, 26)	94 I (LW6)	1	2770015
	0.519	CAMSHAFT, ENG (*3, 6, 14, 16) (INCL 21, 26)	91-93 I (LW6)	1	2770015
	0.519	CAMSHAFT, ENG (*5, 8) (INCL 21, 26)	91-93 I (LW6)	1	2770015
29.	1.837	VALVE, OIL FLTR BYPASS (*1, 2, 3, 4, 5, 6, 7, 8, 9, 10) (AC-DELCO #25013759)	91-96 I (LW6)	1	25013759
30.	0.293	PIN, CYL HD LOC (5/16X9/16 STL) (8.939) (AC-DELCO #585927)	91-96 I (LW6)	8	585927
31.	1.855	FITTING, OIL FLTR (*11, 12, 13, 14, 15, 16, 17, 18, 19, 20)	91-96 I (LW6)	1	3853870
32.	0.096	BEARING KIT, CR/SHF (#1, 2, 3, 4) (.001"U.S.) (0.616)	91-96 I (LW6)	4	12329955
	0.096	BEARING KIT, CR/SHF (#1, 2, 3, 4) (.010"U.S.) (0.616)	91-96 I (LW6)	4	12329957
	0.096	BEARING KIT, CR/SHF (#1, 2, 3, 4) (.020"U.S.) (0.616)	91-96 I (LW6)	4	12329958
	0.096	BEARING KIT, CR/SHF (#1, 2, 3, 4) (.030"U.S.) (0.616)	91-96 I (LW6)	4	12329959
	0.096	BEARING KIT, CR/SHF (#1, 2, 3, 4) (STD)	91-96 I (LW6)	4	12329954
	0.096	BEARING KIT, CR/SHF (#5) (.001"U.S.)	91-96 I (LW6)	1	10048778
	0.096	BEARING KIT, CR/SHF (#5) (STD)	91-96 I (LW6)	1	10147959
	0.096	BEARING KIT, CR/SHF (#5) (0.025" U.S.)	91-94 I (LW6)	1	10147961
	0.096	BEARING KIT, CR/SHF (#5) (0.025" U.S.) (*19, 20, 21, 22) ..	95-96 I (LW6)	1	10147961
33.	8.960	KEY, WOODRUFF #9 .187X.750 PL (CR/SHF GR) (*1, 2, 4, 6, 7, 8, 9, 10, 11, 12, 13, 14, 15)	91-93 I (LW6)	AR	106751

	8.960	KEY, WOODRUFF #9 .187X.750 PL (CR/SHF GR) (*19, 20, 21, 22, 23, 24)	94 I (LW6)	AR	106751
	8.960	KEY, WOODRUFF #9 .187X.750 PL (CR/SHF GR) (*19, 20, 21, 22, 25, 26, 27)	95-96 I (LW6)	1	106751
34.	0.213	SEAL, CR/SHF FRT OIL (TIMING GR CVR)	91-96 I (LW6)	1	10243247
35.	0.728	GEAR, CR/SHF	94-96 I (LW6)	1	2768986
	0.728	GEAR, CR/SHF (*1, 2, 4, 6, 7, 8, 9, 10, 11, 12, 13, 14, 15, 16)	91-93 I (LW6)	1	2768986
36.	0.207	GASKET, ENG FRT CVR (*21, 22, 23, 24, 25, 26, 27)	91-96 I (LW6)	1	14096156
37.	0.206	COVER, ENG FRT (INCL 34, 42, 60)	91-96 I (LW6)	1	3992251
38.	N.S.	ABSORBER, CR/SHF BAL (PART OF 41)	91-96 I (LW6)	1	
39.	N.S.	HUB, CR/SHF BAL (PART OF 41)	91-96 I (LW6)	1	
40.	N.S.	PULLEY, CR/SHF (PART OF 41)	91-96 I (LW6)	1	
41.	0.659	BALANCER, CR/SHF (*1, 2, 3, 4, 6, 7, 9, 10, 11, 12, 13, 15) (INCL 38, 39, 40))	91-93 I (LW6)	1	3826280
	0.659	BALANCER, CR/SHF (*19, 20, 21, 22, 24, 26, 27) (INCL 38, 39, 40))	94 I (LW6)	1	3826280
	0.659	BALANCER, CR/SHF (*19, 20, 21, 22, 25, 26, 27) (INCL 38, 39, 40))	95 I (LW6)	1	3826280
	0.659	BALANCER, CR/SHF (*19, 20, 21, 22, 26, 27) (INCL 38, 39, 40))	96 I (LW6)	1	3826280
	0.659	BALANCER, CR/SHF (*2, 25) (INCL 38, 39, 40))	96 I (LW6)	1	3896590
	0.659	BALANCER, CR/SHF (*23, 25) (INCL 38, 39, 40))	94-95 I (LW6)	1	3896590
	0.659	BALANCER, CR/SHF (*5, 8, 14, 16) (INCL 38, 39, 40))	91-93 I (LW6)	1	3896590
42.	0.213	SEAL, CR/SHF FRT OIL (PART OF 37)	91-96 I (LW6)	1	10243247
43.	8.932	WASHER, EXTERNAL TOOTH LK 7/16 (CR/SHF BAL)	91-96 I (LW6)	6	136857
44.	0.662	BOLT, CR/SHF BAL (1/2-20X1.38)	91-93 I (LW6)	1	10126796
45.	1.428	NUT, OIL PAN (HEX 5/16-18X17/64 THK 286M PC) (8.915)	91-96 I (LW6)	AR	9417954
46.	8.931	WASHER, SPR LK, .263 X .48 .072, ZOR (OIL PAN) (AC-DELCO #9439510)	91-96 I (LW6)	2	9439510
	1.428	WASHER, OIL PAN BOLT (.263X.48X.072) (8.931) (AC-DELCO #9439510)	91-96 I (LW6)	AR	9439510
47.	1.428	BOLT, OIL PAN (1/4-20X5/8 HH 280-ZP) (8.900) (AC-DELCO #180018)	91-96 I (LW6)	AR	180018
48.	1.453	PLUG, OIL PAN DRN (PART OF 50) (1/2-20, .81LG, .44 THD LGTH, .88 FL H D DIA)	91-96 I (LW6)	1	3921988
49.	1.456	GASKET, OIL PAN DRN PLUG (PART OF 50)	91-96 I (LW6)	1	14090908

50.	1.426	PAN, OIL (*1, 3, 4, 7, 11 - 14, 16 SECOND DSGN - 17) (INCL 48, 49))	91-93	I (LW6)	1	9341974C
	1.426	PAN, OIL (*19, 20, 23, 24, 25, 26, 27) (INCL 48, 49))	94	I (LW6)	1	93419740
	1.426	PAN, OIL (*2, 14, 19, 20, 25, 26, 27) (INCL 48, 49))	95-96	I (LW6)	1	93419740
	1.426	PAN, OIL (*2, 5, 6, 8, 13 - 14, 16 FIRST DSGN - 17) (INCL 48, 49))	91-93	I (LW6)	1	93419742
	1.426	PAN, OIL (*21, 22) (INCL 48, 49))	94-96	I (LW6)	1	93419741
	1.426	PAN, OIL (*9, 10, 12, 15) (INCL 48, 49))	91-93	I (LW6)	1	93419741
51.	1.428	BOLT, OIL PAN (HEX 5/16-18X5/8 Z 28OM) (8.900)	91-96	I (LW6)	2	180075
52.	8.906	SCREW, RD HD SLOTTED MA 1/4-20X3/4" CAD/ZC (O/PMP CVR)	91-96	I (LW6)	4	133043
53.	8.931	WASHER, SPR LK, .263 X .48 .072, ZOR (O/PMP CVR) (AC-DELCO #9439510)	91-96	I (LW6)		9439510
	1.723	WASHER, O/PMP CVR (.263X.48X.072) (8.931) (AC-DELCO #9439510)	91-96	I (LW6)	4	9439510
54.	1.723	COVER, O/PMP	91-96	I (LW6)	1	3792507
55.	1.724	GASKET, O/PMP CVR	91-96	I (LW6)	1	3789970
56.	1.609	SPRING, OIL PRESS RLF VLV	91-96	I (LW6)	1	3814903
57.	1.609	PLUG, OIL PRESS RLF VLV BORE (1.531)	91-96	I (LW6)	1	3930824
58.	1.609	VALVE, OIL PRESS RLF	91-96	I (LW6)	1	3829433
59.	1.652	BOLT, O/PMP (5/16-18 X 3/4, 300M) (HEX HD, STEEL) (8.900)	91-96	I (LW6)	3	9424877
60.	N.S.	REINFORCEMENT, ENG FRT CVR LWR FLG (PART OF 37)				
61.	1.429	GASKET, OIL PAN	91-96	I (LW6)	1	14096637
62.	0.206	BOLT, ENG FRT CVR (HFH 1/4-20X.56 280M PZOR) (8.900)	91-96	I (LW6)	1	9439930
	0.206	BOLT, ENG FRT CVR (*1, 6, 14, 15) (HFH 1/4-20X.56 280M PZOR) (8.900)	93	I (LW6)	6	9439930
63.	1.652	PUMP, OIL (*19, 20, 21, 22, 23, 24, 25, 26, 27) (EXC SCREEN & TUBE)	94	I (LW6)	1	14091485
	1.652	PUMP, OIL (*2, 14, 19, 20, 21, 22, 25, 26, 27) (EXC SCREEN & TUBE)	95-96	I (LW6)	1	14091485
	1.652	PUMP, OIL (*2, 5, 6, 8, 13, 14) (EXC SCREEN & TUBE)	91-93	I (LW6)	1	14091485
	1.652	PUMP, OIL (*9, 10, 12, 15, 21, 22) (1.656) (W/SCREEN)	91-96	I (LW6)	1	93415669
64.	0.748	NOZZLE, CM/SHF GR LUB	91-96	I (LW6)	1	3875950
65.	1.656	BRACKET, O/PMP SCRN (PART OF 71) (*9, 10, 12, 15, 21, 22)	91-94	I (LW6)	1	3905965
	N.S.	BRACKET, O/PMP SCRN (PART OF 71) (*1, 3, 4, 7, 11, 16)		I (LW6)	1	
	N.S.	BRACKET, O/PMP SCRN (PART OF 71) (*2, 5, 6, 8, 13, 14)		I (LW6)	1	
	1.656	BRACKET, O/PMP SCRN (PART OF 71) (*21, 22)	95	I (LW6)	1	3905965

	1.656	BRACKET, O/PMP SCRN (PART OF 71) (*19, 20, 25, 26, 27)	95 I (LW6)	1	3970417
	1.656	BRACKET, O/PMP SCRN (PART OF 71) (*19, 20, 23, 24, 25)	94 I (LW6)	1	3970417
	1.656	BRACKET, O/PMP SCRN (PART OF 71) (*2, 14, 19, 20, 25, 26, 27)	96 I (LW6)	1	3970417
66.	0.646	CRANKSHAFT, ENG	91-96 I (LW6)	1	14096624
67.	8.900	BOLT, HEX 1/4-20X3/4 300M PC (O/PMP SCRN BRKT)	91-96 I (LW6)	AR	9425113
68.	8.929	WASHER, 1/4X1/2X1/16 HARD ZP (O/PMP SCRN BRKT)	91-96 I (LW6)	1	2436161
	1.656	WASHER, O/PMP SUC PIPE BRKT (1/4X1/2X1/16) (ZP, HARD) (8.929)	91-96 I (LW6)	AR	2436161
69.	1.652	NUT, O/PMP (*2, 14, 21, 22, 25) (3/8-16, 301M) (HEX LK/TORQ-TENS) (8.917)	96 I (LW6)	1	9422297
	1.652	NUT, O/PMP (*2, 5, 6, 8, 9, 10, 12, 13, 14, 15, 16, 21, 22, 23, 25) (3/8-16, 301M) (HEX LK/TORQ-TENS) (8.917)	91-95 I (LW6)	1	9422297
70.	1.609	PIN, OIL PRESS RLF VLV	91-96 I (LW6)	1	838839
71.	N.S.	SCREEN, O/PMP (W/BRKT) (PART OF 63)	94-96 I (LW6)		
	1.656	SCREEN, O/PMP (W/BRKT) (*2, 5, 6, 8, 13, 14, 16) (INCL 65, 69) (PART OF 63)	91-93 I (LW6)	1	3915988
72.	0.056	BOLT, CR/SHF BRG CAP	91-96 I (LW6)	10	3872781
73.	0.095	CAP, CR/SHF BRG	91-96 I (LW6)	4	3970194
74.	0.137	PIN, CR/SHF RR OIL SEAL HSG LOC (SPRING TYPE S 7/16X9/16 STL ZP) (8.940)	91-96 I (LW6)	1	9441003
75.	0.137	HOUSING, CR/SHF RR OIL SEAL (INCL 80, 81)	91-96 I (LW6)	1	10108477
76.	0.137	BOLT, CR/SHF RR OIL SEAL HSG (HFH, 1/4-20X1.38, .52 OD, .75 THD, 280M, PO)	91-96 I (LW6)	AR	14096659
77.	0.137	BOLT, CR/SHF RR OIL SEAL HSG	91-96 I (LW6)	AR	14096658
78.	0.137	GASKET, CR/SHF RR OIL SEAL HSG	91-96 I (LW6)	1	12337823
79.	0.056	STUD, CR/SHF BRG CAP (*2, 3, 5, 6, 8, 9, 10, 12, 13, 14, 15, 18, 21, 22, 24, 26, 27)	91-96 I (LW6)	1	3852870
80.	0.137	STUD, CR/SHF RR OIL SEAL RET (PART OF 75) (5/16X18X1 43/64, 280M) (1.428)	91-96 I (LW6)	2	14080362
81.	0.137	SEAL, CR/SHF RR OIL (PART OF 75)	91-96 I (LW6)	1	10088158
82.	0.673	GEAR, FLYWHL RING (*1, 2, 3, 4, 7, 9, 10, 11, 12, 13, 15, 19, 20, 21, 22, 24, 25, 26, 27) (PART OF 87))	91-95 I (LW6)	1	3991407
	0.673	GEAR, FLYWHL RING (*19, 20, 21, 22, 24, 26, 27) (PART OF 87))	96 I (LW6)	1	3991407
83.	0.669	WASHER, FLYWHL (*1, 2, 3, 4, 7, 9, 10, 11, 12, 13, 15, 17, 20, 21, 22, 24, 25.) (7/16) (EXT TOOTH LK) (8.932)	91-94 I (LW6)	1	136857

	0.669	WASHER, FLYWHL (*19, 20, 21, 22, 26, 27) (7/16) (EXT TOOTH LK) (8.932)	95-96 I (LW6)	1	136857
84.	0.669	BOLT, FLYWHL (*1, 2, 3, 4, 7, 9, 10, 11, 12, 13, 15, 19, 20, 21, 22, 24, 26, 27)	91-95 I (LW6)	6	839756
	0.669	BOLT, FLYWHL (*19, 20, 21, 22, 26, 27)	96 I (LW6)	6	839756
85.	0.446	BOLT, VLV PUSH ROD CVR	91-96 I (LW6)	4	3814350
86.	0.649	BEARING, CLU PILOT (*1, 4, 7, 11, 19, 20) (NEEDLE BEARING 19/32 I.D. 1 3/32 O.D.X 3/4)	91-96 I (LW6)	1	14061685
87.	0.666	FLYWHEEL, ENG (*1, 2, 3, 4, 7, 9, 10, 11, 12, 13, 15, 19, 20, 21, 22, 24, 26, 27) (INCL 82))	91-95 I (LW6)	1	93422872
	0.666	FLYWHEEL, ENG (*19, 20, 21, 22, 26, 27) (INCL 82))	96 I (LW6)	1	93422872
88.	N.S.	COVER, VLV PUSH ROD (ORIGINAL CVR) (USE 14096155 GASKET))	91-95 I (LW6)		3788548
	0.439	COVER, VLV PUSH ROD (439.5MM X 108.5MM, 4 RD CORNERS) (USE W/10021542 GASKET))	91-96 I (LW6)	1	10024137
89.	0.685	PIN, TRANS LOC (5/8 DIA, 1 3/16 LG) (8.939)	91-96 I (LW6)	2	12338119
90.	0.443	GASKET, VLV PUSH ROD CVR (SEE ITEM #88) (SERVICE ORIGINAL CVR ONLY)	91-95 I (LW6)	AR	14096155
		SEALER, VLV PUSH ROD CVR (RTV SILICONE) (3.35 OZ TUBE) (WHEN REQUIRED) (8.800)	94-96 I (LW6)	AR	12345739
91.	1.531	PLUG, ENG BLK OIL GAL (3/8-18, 27/64 DEEP) (PEOR, STL) (8.971)	91-96 I (LW6)	1	14090911
92.	0.033	ENGINE, 3.0 L (181 CID) SERV PARTIAL (*1, 4, 7, 11, 19, 20, 21, 22, 29) (INCL'S BLK, PSTN & ROD, CR/SHF, CR/SHF BRGS, CONN ROD BRGS, RR SEAL GASKET)	91-95 I (LW6)	1	10159451
	0.033	ENGINE, 3.0 L (181 CID) SERV PARTIAL (*14, 20, 21, 22) (INCL'S BLK, PSTN & ROD, CR/SHF, CR/SHF BRGS, CONN ROD BRGS, RR SEAL GASKET)	96 I (LW6)	1	10159451
	0.033	ENGINE, 3.0 L (181 CID) SERV PARTIAL (*14, 25) (INCL'S BLK, PSTN & ROD, CR/SHF, CR/SHF BRGS, CONN ROD BRGS)	95 I (LW6)	1	12506371
	0.033	ENGINE, 3.0 L (181 CID) SERV PARTIAL (*2, 14, 25) (INCL'S BLK, PSTN & ROD, CR/SHF, CR/SHF BRGS, CONN ROD BRGS)	96 I (LW6)	1	12506371

	0.033	ENGINE, 3.0 L (181 CID) SERV PARTIAL (*2, 6, 9, 10, 12, 13, 15) (*18) (INCL'S BLK, PSTN & ROD, CR/SHF, CR/SHF BRGS, CONN ROD BRGS, RR SEAL GASKET)	91-93 I (LW6)	1	10159451
	0.033	ENGINE, 3.0 L (181 CID) SERV PARTIAL (*26) (INCL'S BLK, PSTN & ROD, CR/SHF, CR/SHF BRGS, CONN ROD BRGS, RR SEAL GASKET)	94 I (LW6)	1	12523704
	0.033	ENGINE, 3.0 L (181 CID) SERV PARTIAL (*26, 27) (INCL'S BLK, PSTN & ROD, CR/SHF, CR/SHF BRGS, CONN ROD BRGS, RR SEAL GASKET)	95-96 I (LW6)	1	12523704
	0.033	ENGINE, 3.0 L (181 CID) SERV PARTIAL (*3, 5, 8, 14, 16, 23, 25, 27) (INCL'S BLK, PSTN & ROD, CR/SHF, CR/SHF BRGS, CONN ROD BRGS)	91-94 I (LW6)	1	12506371
93.	0.553	PLUG, CM/SHF RR BRG HOLE	91-96 I (LW6)	1	3704158
94.	0.034	PLUG, ENG BLK CORE HOLE	91-93 I (LW6)	AR	3826505
	0.034	PLUG, ENG BLK CORE HOLE (*19, 20, 21, 22, 24, 25)	94 I (LW6)	AR	3826505
	0.034	PLUG, ENG BLK CORE HOLE (50.8MM) (CUP TYPE) (*23)	94 I (LW6)	AR	3789860
	0.034	PLUG, ENG BLK CORE HOLE (*19, 20, 21, 22, 26, 27)	95-96 I (LW6)	AR	3826505
	0.034	PLUG, ENG BLK CORE HOLE (50.8MM) (CUP TYPE) (*25)	95-96 I (LW6)	AR	3789860
95.	1.531	PLUG, OIL LVL IND TUBE HOLE	91-96 I (LW6)	1	3848405
96.	1.531	PLUG, ENG BLK OIL GAL (37/64 DIA) (8.970) (FRT END OF ENG BLK AT OIL GALLERY)	91-96 I (LW6)	1	3835577
97.	1.516	TUBE, OIL LVL IND (*02, 14, 24, 25, 26, 27)	95-96 I (LW6)	1	2768595
	1.516	TUBE, OIL LVL IND (*14, 24, 26, 27)	94 I (LW6)	1	2768595
	1.516	TUBE, OIL LVL IND (*3 - 14, 16 SECOND DESIGN - 17 (OEM ENGINE BDCST CODE 2RW W/FRT SUMP OIL PAN.)	91-93 I (LW6)	1	2768595
	1.516	TUBE, OIL LVL IND (*5, 8 - 14, 16 FIRST DESIGN - 17 OEM ENGINE BDCST CODE 2RA W/REAR SUMP OIL PAN.)	91-93 I (LW6)	1	93420020
98.	1.516	INDICATOR, OIL LVL (*2, 14, 25, 26, 27)	95-96 I (LW6)	1	3860099
	1.516	INDICATOR, OIL LVL (*3, 5, 8, 14, 16, 23, 24, 25)	91-94 I (LW6)	1	3860099
100.		SEALER, VLV PUSH ROD CVR (BLACK) (5 OZ. CARTRIDGE) (LOCTITE RTV 5900) (8.800)	95-96 I (LW6)	AR	12346286

NOTE 1: 3.0L 181 CID MARINE ENG. 1991 14097242 (1RT); 1992 14097382 (2RT); 1993 10213737 (3RT).
 NOTE 2: 3.0L 181 CID MARINE ENG. 1991 14097244 (1RS); 1992 14097384 (2RS); 1993 10213741 (3RS), 1996 93427130 (6RS).
 NOTE 3: 3.0L 181 CID MARINE ENG. 1991 14097398 (1RH); 1992 14097399 (2RH); 1993 10213742 (3RH).
 NOTE 4: 3.0L 181 CID MARINE ENG. 1991 14097438 (1RJ); 1992 14097440 (2RJ); 1993 10213743 (3RJ).
 NOTE 5: 3.0L 181 CID MARINE ENG. 1991 14097251 (1RZ); 1992 14097393 (2RZ); 1993 10213758 (3RZ).
 NOTE 6: 3.0L 181 CID MARINE ENG. 1991 14097249 (1RD); 1992 14097391 (2RD); 1993 10213828 (3RD).

NOTE 7: 3.0L 181 CID MARINE ENG. 1991 14097246 (1RX); 1992 14097387 (2RX); 1993 10213829 (3RX).
 NOTE 8: 3.0L 181 CID MARINE ENG. 1991 14097250 (1RY); 1992 14097392 (2RY); 1993 10213830 (3RY).
 NOTE 9: 3.0L 181 CID MARINE ENG. 1991 14097376 (1RB); 1992 14097385 (2RB); 1993 10214171 (3RB).
 NOTE 10: 3.0L 181 CID MARINE ENG. 1991 14097377 (1RC); 1992 14097390 (2RC); 1993 10214172 (3RC).
 NOTE 11: 3.0L 181 CID MARINE ENG. 1991 14097439 (1RK); 1992 14097441 (2RK); 1993 10214176 (3RK).
 NOTE 12: 3.0L 181 CID MARINE ENG. 1991 14097247 (1RR); 1992 14097388 (2RR); 1993 10214178 (3RR).
 NOTE 13: 3.0L 181 CID MARINE ENG. 1991 14097248 (1RU); 1992 14097389 (2RU); 1993 10214179 (3RU).
 NOTE 14: 3.0L 181 CID MARINE ENG. 1991 14097330 (1RA); 1992 14097394 (2RA), 1995 93427533
 (5RA), 1996 93427535 (6RA).
 NOTE 15: 3.0L 181 CID MARINE ENG. 1991 14097243 (1RP), 1992 14097383 (2RP), 1993 10214177 (3RP).
 NOTE 16: 3.0L 181 CID MARINE ENG. 1992 10224590 (2RW); 1993 10224591 (3RW).
 NOTE 17: FIRST DESIGN IS WITH REAR SUMP OIL PAN; SECOND DESIGN IS WITH FRONT SUMP OIL PANL.
 NOTE 18: MAY NEED TO REMOVE RIGHT HAND #4 MAIN BEARING CAP BOLT AND REPLACE WITH #3852870
 STUD (ITEM #79).
 NOTE 19: 3.0L 181 CID MARINE ENG. 1994 10232482 (4RX), 1995 12552044 (5RX), 1996 93427129 (6RX).
 NOTE 20: 3.0L 181 CID MARINE ENG. 1994 10232483 (4RK), 1995 12552042 (5RK), 1996 93427127 (6RK).
 NOTE 21: 3.0L 181 CID MARINE ENG. 1994 10232486 (4RR), 1995 12552043 (5RR), 1996 93427128 (6RR).
 NOTE 22: 3.0L 181 CID MARINE ENG. 1994 10232487 (4RC), 1995 12552041 (5RC), 1996 93427126 (6RC).
 NOTE 23: 3.0L 181 CID INDUSTRIAL ENG. 1994 10232511 (4RW) (CANC REPL BY --> (12551321 (4RN)).
 NOTE 24: 3.0L 181 CID INDUSTRIAL ENG. 1994 10243387 (4RL) (CANC REPL BY --> (12551320 (4RM)).
 NOTE 25: 3.0L 181 CID INDUSTRIAL ENG. 1994 12551321 (4RN), 1995 12552039 (5RN), 1996 93427124 (6RN).
 NOTE 26: 3.0L 181 CID CRUSADER ENG. 1994 12551276 (4RF), 1995 12552040 (5RF), 1996 93427125 (6RF).
 NOTE 27: 3.0L 181 CID INDUSTRIAL ENG. 1994 12551320 (4RM), 1995 12552038 (5RM), 1996 93427123 (6RM).

RPO DEFINITIONS

LW6 - ENGINE, GAS, 4 CYL

OM00-012
101292

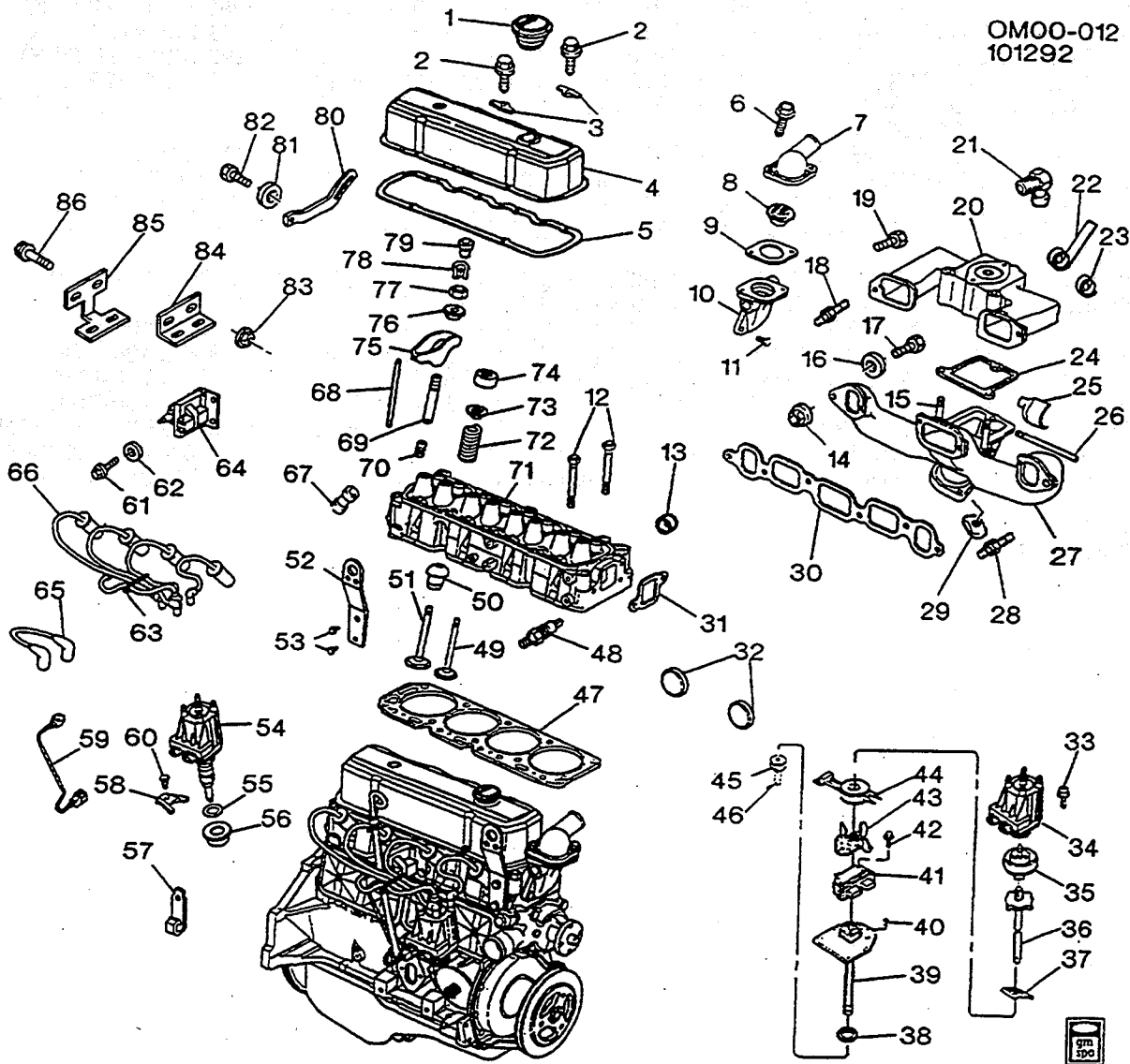

1991-1996 OEM ENGINE ASM-3.0L L4 PART 2

OM00-012D

1.	1.758	CAP, OIL FIL (*1, 2, 3, 5, 6, 7, 8, 9, 10, 12, 13, 14, 15, 16, 19, 21, 22, 23, 24, 25, 26, 27) (AC-DELCO #FC140)	91-96 I (LW6)	1	10110859
2.	0.413	BOLT, VLV RKR ARM CVR (SPL HFH 1/4-20X.87 DOG PT FULL THD PS .52-OD) (1.428)	91-93 I (LW6)	AR	25520079
	0.413	BOLT, VLV RKR ARM CVR (, 300M, PC) (1/4-20 X 1/2, 1/8 THD) (8.900)	94-96 I (LW6)	AR	9442895
3.	0.413	REINFORCEMENT, VLV RKR ARM CVR (*1, 2, 3, 5, 6, 7, 8, 9, 10, 12, 13, 14, 15, 16, 19, 21, 22, 23, 24, 25, 26, 27)	91-96 I (LW6)	AR	3877670
4.	0.386	COVER, VLV RKR ARM (*1, 2, 3, 5, 7, 8, 9, 10, 12, 13, 14, 15, 16, 19, 21, 22, 23, 24, 25, 26, 27) (INCL 57)	91-95 I (LW6)	1	2770089
	0.386	COVER, VLV RKR ARM (*2, 14, 19, 21, 22, 25, 26, 27) (INCL 57)	96 I (LW6)	1	2770089

	0.386	COVER, VLV RKR ARM (*4, 11, 20) (INCL 57)	91-96 (LW6)	1	2769092
	0.386	COVER, VLV RKR ARM (*6) (INCL 57)	91-93 (LW6)	1	2770090
5.	0.423	GASKET, VLV RKR ARM CVR (*1, 2, 3, 5, 6, 7, 8, 9, 10, 12, 13, 14, 15, 16, 19, 21, 22, 23, 24, 25, 26, 27)	91-95 (LW6)	AR	14096154
	0.423	GASKET, VLV RKR ARM CVR (*2, 14, 19, 21, 22, 25, 26, 27)	96 (LW6)	AR	14096154
6.	1.251	BOLT, ENG COOL THERM HSG (*26, 27) (HEX 3/8-16X1.00 300M) (8.900) (AC-DELCO #9424320)	96 (LW6)	3	9424320
	1.251	BOLT, ENG COOL THERM HSG (*3, 5, 6) (HFH 3/8-16X .88 280 POR 0.75 OD 0.72 THD) (8.900)	91-93 (LW6)	2	9440169
	1.251	BOLT, ENG COOL THERM HSG (*3, 5, 6, 24, 26, 27) (HEX 3/8-16X1.00 300M) (8.900) (AC-DELCO #9424320)	91-95 (LW6)	3	9424320
7.	1.153	OUTLET, WAT (*3, 5, 6, 24, 26, 27)	91-96 (LW6)	1	3841191
8.	1.246	THERMOSTAT, ENG COOL (*3, 5, 6, 24, 26, 27) (AC-DELCO #131-84)	91-96 (LW6)	1	10220957
9.	1.154	GASKET, WAT OTLT (*3, 5, 6, 24, 26, 27)	91-96 (LW6)	1	10105135
10.	1.251	HOUSING, ENG COOL THERM (*3, 5, 6, 24, 26, 27)	91-96 (LW6)	1	352705
11.	1.251	BOLT, ENG COOL THERM HSG (*26, 27) (HEX 3/8-16X1.00 300M) (8.900) (AC-DELCO #9424320)	96 (LW6)	3	9424320
	1.251	BOLT, ENG COOL THERM HSG (*3, 5, 6) (HFH 3/8-16X .88 280 POR 0.75 OD 0.72 THD) (8.900)	91-93 (LW6)	2	9440169
	1.251	BOLT, ENG COOL THERM HSG (*3, 5, 6, 24, 26, 27) (HEX 3/8-16X1.00 300M) (8.900) (AC-DELCO #9424320)	91-95 (LW6)	3	9424320
12.	0.293	BOLT, CYL HD (HEX, 1/2-13X3.6, 1041 STZ, PLAIN, MACH, W/SEALER) (USE/W 12346004 SEALANT)	94-96 (LW6)	AR	10166832
	0.293	BOLT, CYL HD (*17) (HEX, 1/2-13X3.6, 1041 STZ, PLAIN, MACH, W/SEALER)	91-93 (LW6)	AR	10166832
13.	0.293	PLUG, CYL HD CORE HOLE (0.034)	91-96 (LW6)	2	3826506
14.	3.604	NUT, EXH MANIF (*2, 25, 26, 27) (3/8-24, 301M ZC) (HEX) (8.915)	96 (LW6)	8	225854
	3.604	NUT, EXH MANIF (*8, 9, 11, 16, 23, 24, 25, 26, 27) (3/8-24, 301M ZC) (HEX) (8.915)	91-95 (LW6)	8	225854
15.	3.275	STUD, INT MANIF (*2, 25, 26, 27) (STRAIGHT, NO THDS "A" SIDE, 3/8-16X0.3, 0.9 TOTAL LEN, 1018, PLAIN)	96 (LW6)	2	3835487

	3.275	STUD, INT MANIF (*3, 5, 8, 14, 16, 23, 24, 25, 26, 27) (STRAIGHT, NO THDS "A" SIDE, 3/8-16X0.3, 0.9 TOTAL LEN, 1018, PLAIN)	91-95 I (LW6)		
16.	3.275	WASHER, EXH MANIF (*2, 25, 26, 27) (#10X18.30) (LK) (8.931) (*M10 HOLE SIZE X 18.30 OD X .117 THK)	96 I (LW6)	AR	11500046
	3.275	WASHER, EXH MANIF (*24, 25, 26, 27) (#10X18.30) (LK) (8.931) (*M10 HOLE SIZE X 18.30 OD X .117 THK)	93-95 I (LW6)	AR	11500046
	3.275	WASHER, EXH MANIF (*3, 5, 8, 14, 16, 23, 24, 25, 26, 27) (29/64 X 49/64 X 7/64) (HEL SPR LK) (8.931)	91-96 I (LW6)	6	9439513
17.	3.275	BOLT, EXH MANIF (*2, 25, 26, 27) (HEX 3/8-16X1.00 300M) (8.900) (AC-DELCO #9424320)	96 I (LW6)	3	9424320
	3.275	BOLT, EXH MANIF (*3, 5, 8, 14, 16, 23, 24, 25, 26, 27) (HEX 3/8-16X1.00 300M) (8.900) (AC-DELCO #9424320)	91-95 I (LW6)	3	9424320
18.	3.275	STUD, EXH MANIF (*2, 25, 26, 27)	96 I (LW6)	1	3794230
	3.275	STUD, EXH MANIF (*3, 5, 8, 14, 16, 23, 24, 25, 26, 27)	91-95 I (LW6)	1	3794230
19.	3.275	BOLT, INT MANIF (*3, 5, 8, 14, 16, 24, 26, 27) (3/8-16 X 1 1/4, 300M) (HEX) (8.900)	91-96 I (LW6)	AR	9440954
20.	3.265	MANIFOLD, INT (*2, 25, 26, 27)	96 I (LW6)	1	5743050
	3.265	MANIFOLD, INT (*3, 5, 8, 14, 16, 23, 24, 25, 26, 27)	91-95 I (LW6)	1	5743050
21.	3.278	FITTING, INT MANIF VAC (*26, 27)	96 I (LW6)	1	3989020
	3.278	FITTING, INT MANIF VAC (*3, 24, 26, 27)	91-95 I (LW6)	1	3989020
22.	3.641	SPRING, EFE VLV A/RTL (*2, 25)	96 I (LW6)	1	602799
	3.641	SPRING, EFE VLV A/RTL (*5, 8, 14, 16, 23, 25)	91-95 I (LW6)	1	602799
23.	3.640	THERMOSTAT, EFE VLV (*2, 25)	96 I (LW6)	1	838573
	3.640	THERMOSTAT, EFE VLV (*5, 8, 14, 16, 23, 25)	91-95 I (LW6)	1	838573
24.	3.270	GASKET, EXH MANIF (*3, 5, 8, 14, 23, 24, 25, 26, 27)	91-95 I (LW6)	1	10141249
	3.270	GASKET, EXH MANIF (*5, 25, 26, 27)	96 I (LW6)	1	10141249
25.	3.140	BUSHING, EFE VLV SHF (*5, 8, 14) (3.647)	91-93 I (LW6)	2	3848282
26.	N.S.	SHAFT, EFE VLV (PART OF 27) (*5, 8, 14, 23, 25)			
27.	3.601	MANIFOLD, EXH (*2, 25) (INCL 26)	96 I (LW6)	1	458432
	3.601	MANIFOLD, EXH (*26, 27) (INCL 26)	96 I (LW6)	1	470146
	3.601	MANIFOLD, EXH (*3, 24, 26, 27) (INCL 26)	91-95 I (LW6)	1	470146

	3.601	MANIFOLD, EXH (*5, 8, 14, 16, 23) (INCL 26)	91-95 (LW6)	1	458432
28.	3.613	STUD, EXH PIPE (*2, 25)	96 (LW6)	2	14088827
	3.613	STUD, EXH PIPE (*3, 5, 8, 14, 16, 23, 24, 25, 26, 27)	91-95 (LW6)	2	14088827
29.	3.273	CLAMP, INT & EXH MANIF (*26, 27)	96 (LW6)	4	3792519
	3.273	CLAMP, INT & EXH MANIF (*3, 5, 8, 14, 16, 23, 24, 25, 26, 27)	91-95 (LW6)	4	3792519
30.	3.270	GASKET, INT MANIF (*2, 25, 26, 27)	96 (LW6)	1	12517943
	3.270	GASKET, INT MANIF (*3, 5, 8, 14, 16, 23, 24, 25, 26, 27)	91-95 (LW6)	1	12517943
31.	1.252	GASKET, ENG COOL THERM HSG (*26, 27)	96 (LW6)	1	10140501
	1.252	GASKET, ENG COOL THERM HSG (*3, 5, 6, 24, 26, 27)	91-95 (LW6)	1	10140501
32.	0.034	PLUG, ENG BLK CORE HOLE (*1, 2, 3, 4, 5, 6, 7, 8, 9, 10, 11, 12, 13, 14, 15, 19, 20, 21, 22, 24, 26, 27) (BRASS) (AC-DELCO #3826504)	91-95 (LW6)	AR	3826504
	8.970	PLUG, WATER JACKET-SIDE DIAM 41.5MM (ENG BLK CORE HOLE) (*16, 23, 25) (10.000) ...	91-95 (LW6)	AR	838538
	0.034	PLUG, ENG BLK CORE HOLE (*19, 20, 21, 22, 26, 27) (BRASS) (AC-DELCO #3826504)	96 (LW6)	AR	3826504
	8.970	PLUG, WATER JACKET-SIDE DIAM 41.5MM (ENG BLK CORE HOLE) (*2, 14, 25) (10.000)	96 (LW6)	AR	838538
33.	2.368	BOLT, DISTR CAP (PART OF 54) (AC-DELCO #10469669)	91-96 (LW6)	2	10469669
34.	2.367	CAP, DISTR (PART OF 54)	91-95 (LW6)	1	10469698
	2.367	CAP, DISTR (PART OF 54) (AC-DELCO #D315A)	91-96 (LW6)	1	10476237
35.	2.382	ROTOR, DISTR (PART OF 54) (AC-DELCO #D450)	91-96 (LW6)	1	10467546
36.	2.372	SHAFT, DISTR (PART OF 54) (AC-DELCO #10468359)	91-96 (LW6)	1	10468359
37.	2.372	RETAINER, DISTR IGN PICK UP COIL (PART OF 54)	91-96 (LW6)	1	10469665
38.	2.363	SEAL, DISTR HSG OIL (O RING) (PART OF 54) (AC-DELCO #10475880)	91-96 (LW6)	1	10475880
39.	2.362	HOUSING, DISTR (PART OF 54) (AC-DELCO #10468362)	91-96 (LW6)	1	10468362
40.	2.372	PIN, DISTR IGN PICK UP POLE PIECE LOC (PART OF 54) (1/8 X 1/2 ZN) (CHAMFERED ENDS, ZINC PLT) (3.459)	91-96 (LW6)	1	454666
41.	2.383	MODULE, DISTR IGN CONT (PART OF 54) (AC-DELCO #D1965A)	91-96 (LW6)	1	16139399
42.	2.383	BOLT, DISTR ICM (PART OF 54) (AC-DELCO #10469668)	91-96 (LW6)	2	10469668
43.	2.372	POLE PIECE, DISTR PICK UP (PART OF 54) (AC-DELCO #10469667)	91-96 (LW6)	1	10469667

44.	2.372	COIL, DISTR PICK UP (PART OF 54) (AC-DELCO #D1944A)	91-96 I (LW6)	1	10470794
45.	2.374	GEAR, DISTR SHF (PART OF 54) (AC-DELCO #10468365)	91-96 I (LW6)	1	10468365
46.	2.379	PIN, DISTR GR (PART OF 54) (8.939) (AC-DELCO #9422127)	91-96 I (LW6)	1	9422127
47.	0.289	GASKET, CYL HD	91-96 I (LW6)	1	14096660
48.	2.270	SPARKPLUG, (AC MR 43T - *1, 2, 4, 9, 15) (AC-DELCO #MR43T)	91-93 I (LW6)	4	5613438
	2.270	SPARKPLUG, (AC MR43LTS - *7, 10, 11, 12, 13, 19, 20, 21, 22) (AC-DELCO #MR43LTS)	91-95 I (LW6)	1	5614210
	2.270	SPARKPLUG, (AC MR43LTS) - (*19, 20, 21, 22) (AC-DELCO #MR43LTS)	96 I (LW6)	1	5614210
	2.270	SPARKPLUG, (AC R45T - *6) (AC-DELCO #R45T)	91-93 I (LW6)	4	5613875
	2.270	SPARKPLUG, (AC R46TS6 - *3, 5, 8, 14, 16, 23, 24, 25, 26, 27) (AC-DELCO #R46TS)	91-95 I (LW6)	4	5613326
	2.270	SPARKPLUG, (AC R46TS6) - *2, 14, 25, 26, 27) (AC-DELCO #R46TS)	96 I (LW6)	4	5613326
49.	DISCON	VALVE, EXH (.0035 O.S.) (*19, 20, 21, 22)	96 I (LW6)	4	3940912
	DISCON	VALVE, EXH (.0035 O.S.) (*7, 10, 11, 12, 13, 19, 20, 21, 22)	91-95 I (LW6)	4	3940912
	DISCON	VALVE, EXH (.0035"O.S.) (*3, 5, 6, 8, 14, 16)	91-93 I (LW6)	4	6263774
	DISCON	VALVE, EXH (.0035"O.S.) (1ST DES ID BY ENG STAMPING CODES 4RL, 4RW. NO COMPARABLE2ND DES.) (*23)	94 I (LW6)	4	6263774
	0.297	VALVE, EXH (.0035"O.S.) (2ND DES ID BY ENG STAMPING CODES 4RM, 4RN.) (*23)	94 I (LW6)	8	14082312
	DISCON	VALVE, EXH (.0155 O.S.) (*19, 20, 21, 22)	96 I (LW6)	4	3940913
	DISCON	VALVE, EXH (.0155 O.S.) (*3, 5, 6, 8, 14, 16)	91-93 I (LW6)	4	6263775
	DISCON	VALVE, EXH (.0155 O.S.) (*7, 10, 11, 12, 13, 19, 20, 21, 22)	91-95 I (LW6)	4	3940913
	DISCON	VALVE, EXH (.0155 O.S.) (1ST DES ID BY ENG STAMPING CODES 4RL, 4RW.) (*23)	94 I (LW6)	4	6263775
	0.297	VALVE, EXH (.0155" O.S.) (2ND DES ID BY ENG STAMPING CODES 4RM, 4RN.) (*23)	94 I (LW6)	4	14082313
	DISCON	VALVE, EXH (.0305 O.S.) (*19, 20, 21, 22)	96 I (LW6)	4	3940914
	DISCON	VALVE, EXH (.0305 O.S.) (*3, 5, 6, 8, 14, 16)	91-93 I (LW6)	4	6263776
	DISCON	VALVE, EXH (.0305 O.S.) (*7, 10, 11, 12, 13, 19, 20, 21, 22)	91-95 I (LW6)	4	3940914
	DISCON	VALVE, EXH (.0305 O.S.) (1ST DES ID BY ENG STAMPING CODES 4RL, 4RW.) (*23)	94 I (LW6)	4	6263776

	0.297	VALVE, EXH (*1, 2, 4, 9, 15) (.0305" O.S.)	91-93 I (LW6)	4	14033160
	0.297	VALVE, EXH (*1, 2, 4, 9, 15)	91-93 I (LW6)	4	14088641
	0.297	VALVE, EXH (*1, 2, 4, 9, 15) (.0035 O.S.)	91-93 I (LW6)	4	14095459
	0.297	VALVE, EXH (*1, 2, 4, 9, 15) (.0155" O.S.)	91-93 I (LW6)	4	14095460
	0.297	VALVE, EXH (*19, 20, 21, 22) (STD)	96 I (LW6)	4	3937750
	0.297	VALVE, EXH (*7, 10, 11, 12, 13, 19, 20, 21, 22) (STD)	91-95 I (LW6)	4	3937750
	0.297	VALVE, EXH (STD) (*2, 14, 25, 26, 27)	96 I (LW6)	4	14082305
	0.297	VALVE, EXH (STD) (*3, 5, 6, 8, 14, 16)	91-93 I (LW6)	4	6263778
	0.297	VALVE, EXH (STD) (1ST DES ID BY ENG STAMPING CODES 4RL, 4RW.) (*23, 24)	94 I (LW6)	4	6263778
	0.297	VALVE, EXH (STD) (2ND DES ID BY ENG STAMPING CODES 4RM, 4RN.) (*14, 25, 26, 27)	94-95 I (LW6)	4	14082305
50.	N.S.	INSERT, VLV PUSH ROD SPHER (PART OF 68)	91-96 I (LW6)	AR	
51.	0.296	VALVE, INT (.0035 OS) (*1, 2, 3, 4, 5, 6, 8, 9, 14, 15, 16, 23)	91-95 I (LW6)	4	3997749
	0.296	VALVE, INT (.0035" O.S.) (*19, 20, 21, 22) (.0035 O.S.)	96 I (LW6)	4	14075642
	0.296	VALVE, INT (.0035" O.S.) (*7, 10, 11, 12, 13, 19, 20, 21, 22) (.0035 O.S.)	91-95 I (LW6)	4	14075642
	0.296	VALVE, INT (.0155 O.S.) (*1, 2, 3, 4, 5, 6, 8, 9, 14, 15, 16, 23)	91-95 I (LW6)	4	3997750
	0.296	VALVE, INT (.0155 O.S.) (*19, 20, 21, 22) (.0155 O.S.)	96 I (LW6)	4	14075643
	0.296	VALVE, INT (.0155 O.S.) (*7, 10, 11, 12, 13, 19, 20, 21, 22) (.0155 O.S.)	91-95 I (LW6)	4	14075643
	0.296	VALVE, INT (.0305 O.S.) (*1, 2, 3, 4, 5, 6, 8, 9, 14, 15, 16, 23)	91-95 I (LW6)	AR	3997751
	0.296	VALVE, INT (.0305 O.S.) (*19, 20, 21, 22) (.0305 O.S.)	96 I (LW6)	4	14075644
	0.296	VALVE, INT (.0305 O.S.) (*7, 10, 11, 12, 13, 19, 20, 21, 22) (.0305 O.S.)	91-95 I (LW6)	4	14075644
	0.296	VALVE, INT (STD) (*1, 2, 3, 4, 5, 6, 8, 9, 14, 15, 16, 23, 24, 25, 26, 27)	91-95 I (LW6)	4	3989088
	0.296	VALVE, INT (STD) (*2, 14, 25, 26, 27)	96 I (LW6)	4	3989088
	0.296	VALVE, INT (STD) (*7, 10, 11, 12, 13, 19, 20, 21, 22) (STD)	91-96 I (LW6)	4	14075641
52.	0.004	BRACKET, ENG LIFT FRT	96 I (LW6)	1	6273484
	0.004	BRACKET, ENG LIFT FRT (*1, 2, 4, 7, 9, 10, 11, 12, 13, 15, 19, 20, 21, 22)	91-95 I (LW6)	1	6273484
53.	0.004	BOLT, ENG LIFT FRT BRKT (3/8-16X3/4) (HEX HD) (8.900)	95-96 I (LW6)	8	9439905

	0.004	BOLT, ENG LIFT FRT BRKT (*1, 2, 4, 7, 910, 11, 12, 13, 15, 19, 20, 21, 22, 25, 26, 27) (3/8-16X3/4) (8.900)	91-95 I (LW6)	2	9442052
54.	2.361	DISTRIBUTOR, (INCL 33, 34, 35, 36, 37, 38, 39, 40, 41, 42, 43, 44, 45, 46)	91-96		
55.	2.363	GASKET, DISTR (AC-DELCO #10132896)	91-96 I (LW6)	1	10132896
56.	2.379	WASHER, DISTR DRVN GR THR	91-96 I (LW6)	1	3792285
57.	DISCON	CLIP, ENG WRG HARN (PART OF 4) (*1, 2, 3, 5, 7, 8, 9, 10, 12, 13, 14, 15, 16, 19, 21, 22, 23, 24, 25, 26, 27)	91-96 I (LW6)	2	9798433
	8.950	CLIP, CLOSED TUBE-.437, ATTACH HOLE .343A:.62, STL W/NEOPRENE COATING (ENG WRG HARN) (PART OF 4) (*6) ..	91-93 I (LW6)	AR	652035
58.	2.363	CLAMP, DISTR IGN	91-96 I (LW6)	1	355780
59.	2.240	WIRE, IGN COIL (AC-DELCO #12097982)	91-96 I (LW6)	1	12097982
60.	2.363	BOLT, DISTR CLA (HEX 3/8-16X1.00 300M) (8.900) (AC-DELCO #9424320)	91-96 I (LW6)	3	9424320
61.	2.183	BOLT, IGN COIL (*1, 2, 3, 5, 6, 7, 8, 9, 10, 13, 14, 16, 19, 22, 23, 24, 25, 26, 27) (3/8-16 5/8) (8.900)	91-95 I (LW6)	1	9428638
	2.183	BOLT, IGN COIL (*2, 14, 19, 22, 25, 26, 27) (3/8-16 5/8) (8.900) .	96 I (LW6)	1	9428638
62.	2.170	WASHER, IGN COIL (25/64 X 53/64 X 5/64) (8.929)	91-96 I (LW6)	2	120394
63.	2.251	RETAINER, SPLG WIRE (*2, 14, 25, 26, 27)	96 I (LW6)	AR	1625931
	2.251	RETAINER, SPLG WIRE (*3, 5, 8, 14, 16, 23, 24, 25, 26, 27)	91-95 I (LW6)	AR	1625931
64.	2.170	COIL, IGN (*1, 2, 3, 5, 6, 7, 8, 9, 10, 13, 14, 16, 19, 22, 23, 24, 25, 26, 27) (AC-DELCO #D535) ...	91-96 I (LW6)	1	1115315
65.	2.240	WIRE, IGN COIL	91-96 I (LW6)	1	93420019
66.	2.239	HARNESS, SPLG WIRE (*2, 14, 25, 26, 27)	96 I (LW6)	1	93420018
	2.239	HARNESS, SPLG WIRE (*3, 5, 8, 14, 16, 23, 24, 25, 26, 27)	91-95 I (LW6)	1	93420018
67.	0.459	LIFTER, VLV (AC-DELCO #HL66)	91-93 I (LW6)	8	5232720
	0.459	LIFTER, VLV (*19, 20, 21, 22, 23, 24, 25, 26, 27) (AC-DELCO #HL66)	94 I (LW6)	8	5232720
	0.459	LIFTER, VLV (*2, 14, 19, 20, 21, 22, 25, 26, 27) (AC-DELCO #HL66)	95-96 I (LW6)	8	5232720
68.	0.426	ROD, VLV PUSH (INCL 50)	91-96 I (LW6)	8	93414888
69.	0.429	STUD, VLV RKR ARM BALL (.003" O.S.)	91-96 I (LW6)	8	3814692
	0.429	STUD, VLV RKR ARM BALL (.013" O.S.)	91-96 I (LW6)	8	3815892
70.	0.308	SEAL, VLV STEM OIL (O-RING TYPE) (EXH & INTAKE)	91-96 I (LW6)	8	10214034

71.	0.269	HEAD, CYL (*1, 2, 3, 4, 5, 6, 8, 9, 14, 15, 16)	91-93 I (LW6)	1	10159444
	0.269	HEAD, CYL (*14, 25, 26, 27)	95 I (LW6)	1	12523506
	0.269	HEAD, CYL (*19, 20, 21, 22)	96 I (LW6)	1	10140599
	0.269	HEAD, CYL (*2, 14, 25, 26, 27)	96 I (LW6)	1	12523506
	0.269	HEAD, CYL (*23, 24) (1ST DES ID BY ENG STAMPING CODES 4RL, 4RW)	94 I (LW6)	1	10159444
	0.269	HEAD, CYL (*25, 26, 27) (2ND DES ID BY ENG STAMPING CODES 4RM, 4RN.) (VALVE STEM HAVE LARGER DIA FOR 2ND DES)	94 I (LW6)	1	12523506
	0.269	HEAD, CYL (*7, 10, 11, 12, 13, 19, 20, 21, 22)	91-95 I (LW6)	1	10140599
72.	0.303	SPRING, VLV (*1, 2, 4, 7, 9, 10, 11, 12, 13, 15, 19, 20, 21, 22) (STEM DIA.8MM) (THE 8-DIGIT HEAD CAST NBR IS NOT FOLLOWED BY "S".)	91-95 I (LW6)	8	14076469
	0.303	SPRING, VLV (*19, 20, 21, 22) (STEM DIA.8MM) (THE 8-DIGIT HEAD CAST NBR IS NOT FOLLOWED BY "S".)	96 I (LW6)	8	14076469
	0.303	SPRING, VLV (*2, 14, 25, 26, 27)	96 I (LW6)	8	3735381
	0.303	SPRING, VLV (*3, 5, 6, 8, 14, 16, 23, 24, 25, 26, 27)	91-95 I (LW6)	8	3735381
73.	0.309	CAP, VLV SPR (*1, 2, 3, 4, 5, 6, 7, 8, 9, 10)	91-96 I (LW6)	8	10038209
	0.309	CAP, VLV SPR (*11, 12, 13, 14, 15, 16, 17, 18, 19, 20)	91-96 I (LW6)	8	10038209
	0.309	CAP, VLV SPR (*21, 22, 23, 24, 25, 26, 27)	91-96 I (LW6)	8	10038209
74.	0.308	SHIELD, VLV STEM OIL	91-96 I (LW6)	12	10007818
75.	0.333	ARM KIT, VLV RKR (W/BALL) ...	91-96 I (LW6)	8	5723551
76.	0.429	BALL, VLV RKR ARM	91-95 I (LW6)	8	3992294
	0.429	BALL, VLV RKR ARM (*14)	96 I (LW6)	8	3992294
77.	0.429	NUT, VLV RKR ARM	91-96 I (LW6)	8	465934
78.	0.310	KEY, VLV STEM	91-96 I (LW6)	16	24503856
79.	0.309	ROTATOR, VLV (*2, 14, 25, 26, 27) (EXH)	95-96 I (LW6)	4	14042575
	0.309	ROTATOR, VLV (*3, 5, 6, 8, 14, 16, 23, 24, 25, 26, 27) (EXH) ...	91-94 I (LW6)	4	14042575
80.	2.277	BRACE, GEN (*3, 5, 24, 26, 27) (2.317)	91-96 I (LW6)	1	6270047
81.	8.931	WASHER, SPR LK 7/16 X 25/32 X 7/64 ZOR (GEN BR) (*3, 5, 23, 24, 25, 26, 27)	91-96 I (LW6)	1	9439513
82.	2.277	BOLT, GEN BR (*3, 5, 24, 26, 27) (3/8-16X3/4) (HEX HD) (8.900) .	91-96 I (LW6)	8	9439905
83.	8.915	NUT, HEX W/CON WA, M4X.7X4.5, 5, NO (IGN COIL BRKT) (*1, 2, 3, 5, 6, 7, 8, 9, 10, 13, 14, 16, 19, 22, 23, 24, 25, 26, 27)	91-95 I (LW6)	AR	10180301
84.	2.183	BRACKET, IGN COIL (TOP) (*1, 2, 3, 5, 6, 7, 8, 9, 10, 13, 14, 16, 19, 22, 23, 24, 25, 26, 27) (2.170) (AC-DELCO #10468368)	91-96 I (LW6)	1	10468368

- 85. 2.183 BRACKET, IGN COIL (BOTTOM) 91-96 I (LW6)
(*1, 2, 3, 5, 6, 7, 8, 9, 10, 13, 14,
16, 19, 22, 23, 24, 25, 26, 27)
(2.170) (AC-DELCO #10468367)
- 86. 8.900 BOLT, HWH M4X0.7X30 9.8 PC 91-96 I (LW6) AR 11507041
(IGN COIL BRKT) (*1, 2, 3, 5, 6,
7, 8, 9, 10, 13, 14, 16, 19, 22, 23,
24, 25, 26, 27)

NOTE 1: 3.0L 181 CID MARINE ENG. 1991 14097242 (1RT), 1992 14097382 (2RT), 1993 10213737 (3RT).
NOTE 2: 3.0L 181 CID MARINE ENG. 1991 14097244 (1RS); 1992 14097384 (2RS); 1993 10213741 (3RS), 1996
93427130 (6RS).

NOTE 3: 3.0L 181 CID MARINE ENG. 1991 14097398 (1RH); 1992 14097399 (2RH); 1993 10213742 (3RH).

NOTE 4: 3.0L 181 CID MARINE ENG. 1991 14097438 (1RJ), 1992 14097440 (2RJ), 1993 10213743 (3RJ).

NOTE 5: 3.0L 181 CID MARINE ENG. 1991 14097251 (1RZ), 1992 14097393 (2RZ), 1993 10213758 (3RZ).

NOTE 6: 3.0L 181 CID MARINE ENG. 1991 14097249 (1RD), 1992 14097391 (2RD), 1993 10213828 (3RD).

NOTE 7: 3.0L 181 CID MARINE ENG. 1991 14097246 (1RX), 1992 14097387 (2RX), 1993 10213829 (3RX).

NOTE 8: 3.0L 181 CID MARINE ENG. 1991 14097250 (1RY), 1992 14097392 (2RY), 1993 10213830 (3RY).

NOTE 9: 3.0L 181 CID MARINE ENG. 1991 14097376 (1RB), 1992 14097385 (2RB), 1993 10214171 (3RB).

NOTE 10: 3.0L 181 CID MARINE ENG. 1992 14097377 (1RC), 1992 14097390 (2RC), 1993 10214172 (3RC).

NOTE 11: 3.0L 181 CID MARINE ENG. 1992 14097439 (1RK), 1992 14097441 (2RK), 1993 10214176 (3RK).

NOTE 12: 3.0L 181 CID MARINE ENG. 1992 14097247 (1RR), 1992 14097388 (2RR), 1993 10214178 (3RR).

NOTE 13: 3.0L 181 CID MARINE ENG. 1991 14097248 (1RU), 1992 14097389 (2RU), 1993 10214179 (3RU).

NOTE 14: 3.0L 181 CID MARINE ENG. 1991 14097330 (1RA), 1992 14097394 (2RA), 1995
93427532 (5RA), 1996 93427535 (6RA).

NOTE 15: 3.0L 181 CID MARINE ENG. 1991 14097243 (1RP), 1992 14097383 (2RP), 1993 10214177 (3RP).

NOTE 16: 3.0L 181 CID MARINE ENG. 1992 10224590 (2RW), 1993 10224591 (3RW).

NOTE 17: APPLY 12346004 THREAD SEALER TO BOLT IF PRE-APPLIED SEALER IS NOT PRESENT.

NOTE 19: 3.0L 181 CID MARINE ENG. 1994 10232482 (4RX), 1995 12552044 (5RX), 1996 93427129 (6RX).

NOTE 20: 3.0L 181 CID MARINE ENG. 1994 10232483 (4RK), 1995 12552042 (5RK), 1996 93427127 (6RK).

NOTE 21: 3.0L 181 CID MARINE ENG. 1994 10232486 (4RR), 1995 12552043 (5RR), 1996 93427128 (6RR).

NOTE 22: 3.0L 181 CID MARINE ENG. 1994 10232487 (4RC), 1995 12552041 (5RC), 1996 93427126 (6RC).

NOTE 23: 3.0L 181 CID INDUSTRIAL ENG. 1994 10232511 (4RW) (CANC REPL BY--> 12551321(4RN).

NOTE 24: 3.0L 181 CID INDUSTRIAL ENG. 1994 10243387 (4RL) (CANC REPL BY--> 12551320(4RM).

NOTE 25: 3.0L 181 CID INDUSTRIAL ENG. 1994 12551321 (4RN), 1995 12552039 (5RN), 1996 93427124 (6RN).

NOTE 26: 3.0L 181 CID CRUSADER ENG. 1994 12551276 (4RF), 1995 12552040 (5RF), 1996 93427125 (6RF).

NOTE 27: 3.0L 181 CID INDUSTRIAL ENG. 1994 12551320 (4RM), 1995 12552038 (5RM), 1996 93427123 (6RM).

RPO DEFINITIONS

LW6 - ENGINE, GAS, 4 CYL