

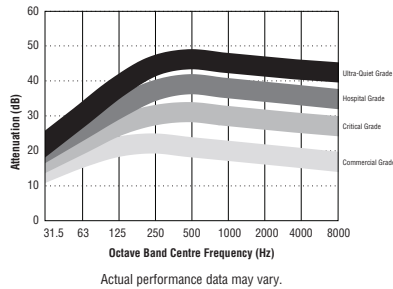

# Cylindrical Silencers

QuietShield silencers are designed for engine and compressor applications that require high quality, durable sound attenuation. The silencers have a high-performance internal design that delivers superior sound reduction in a smaller size when compared to a conventional silencer.

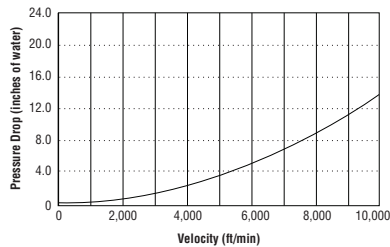

Actual performance data may vary.

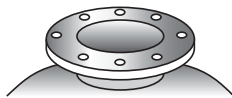

**"125/150# ANSI" Mounting Flange:**  
Bore sizes 4" and above.



**"B" Male Pipe Threads:**  
NPT pipe end offered in sizes < 4".

	Commercial	Critical	Hospital	Ultra-Quiet
<b>Attenuation Level</b>	15–25 dB(A)	25–35 dB(A)	35–42 dB(A)	42–50 dB(A)
<b>Orientation</b>	Horizontal or Vertical	Horizontal or Vertical	Horizontal or Vertical	Horizontal or Vertical
<b>Pipe Threads</b>	2 in–3.5 in bore, NPT external thread	2 in–3.5 in bore, NPT external thread	2 in–3.5 in bore, NPT external thread	2 in–3.5 in bore, NPT external thread
<b>Standard Plate Flange</b>	4 in–22 in bore, drilled to 125/150# ANSI standard	4 in–22 in bore, drilled to 125/150# ANSI standard	4 in–22 in bore, drilled to 125/150# ANSI standard	4 in–22 in bore, drilled to 125/150# ANSI standard
<b>Optional Flanges</b>	BS10, JIS, DIN and others	BS10, JIS, DIN and others	BS10, JIS, DIN and others	BS10, JIS, DIN and others
<b>Finish</b>	Silver high heat paint	Silver high heat paint	Silver high heat paint	Silver high heat paint
<b>Standard Material</b>	Mild steel	Mild steel	Mild steel	Mild steel
<b>Optional Material</b>	< 20 inch O.D., Aluminized steel Stainless steel grades 304L, 316 & 409	< 20 inch O.D., Aluminized steel Stainless steel grades 304L, 316 & 409	< 20 inch O.D., Aluminized steel Stainless steel grades 304L, 316 & 409	< 20 inch O.D., Aluminized steel Stainless steel grades 304L, 316 & 409
<b>Configuration Types</b>	Type 1 and 3	Type 1, 2 and 3	Type 1, 2 and 3	Type 1 and 3
<b>Standard Low Skin Temperature</b>	N/A	Type 2 Configurations	Type 2 Configurations	All Configurations
<b>Optional Assemblies</b>	<ul style="list-style-type: none"> <li>Rain Caps</li> <li>Wye Connections</li> <li>Flex Connectors</li> <li>Expansion Joint Connectors</li> <li>Elbows</li> <li>Straight Tube</li> <li>Exhaust Pipe</li> <li>Attachment Brackets</li> <li>Nut, Bolt &amp; Gasket Kits</li> <li>Gaskets</li> <li>Reduction Flanges</li> <li>Companion Flange Kits</li> <li>Insulation Blankets</li> </ul>	<ul style="list-style-type: none"> <li>Rain Caps</li> <li>Wye Connections</li> <li>Flex Connectors</li> <li>Expansion Joint Connectors</li> <li>Elbows</li> <li>Straight Tube</li> <li>Exhaust Pipe</li> <li>Attachment Brackets</li> <li>Nut, Bolt &amp; Gasket Kits</li> <li>Gaskets</li> <li>Reduction Flanges</li> <li>Companion Flange Kits</li> <li>Insulation Blankets</li> </ul>	<ul style="list-style-type: none"> <li>Rain Caps</li> <li>Wye Connections</li> <li>Flex Connectors</li> <li>Expansion Joint Connectors</li> <li>Elbows</li> <li>Straight Tube</li> <li>Exhaust Pipe</li> <li>Attachment Brackets</li> <li>Nut, Bolt &amp; Gasket Kits</li> <li>Gaskets</li> <li>Reduction Flanges</li> <li>Companion Flange Kits</li> <li>Insulation Blankets</li> </ul>	<ul style="list-style-type: none"> <li>Rain Caps</li> <li>Wye Connections</li> <li>Flex Connectors</li> <li>Expansion Joint Connectors</li> <li>Elbows</li> <li>Straight Tube</li> <li>Exhaust Pipe</li> <li>Attachment Brackets</li> <li>Nut, Bolt &amp; Gasket Kits</li> <li>Gaskets</li> <li>Reduction Flanges</li> <li>Companion Flange Kits</li> <li>Insulation Blankets</li> </ul>

⚠: All information correct at time of printing. Universal has a policy of continuous improvement. Therefore we reserve the right to change the specifications of these silencers without notice.

## Type 3 Configuration

### Side-In End-Out

Commercial Grade (15–25 db)

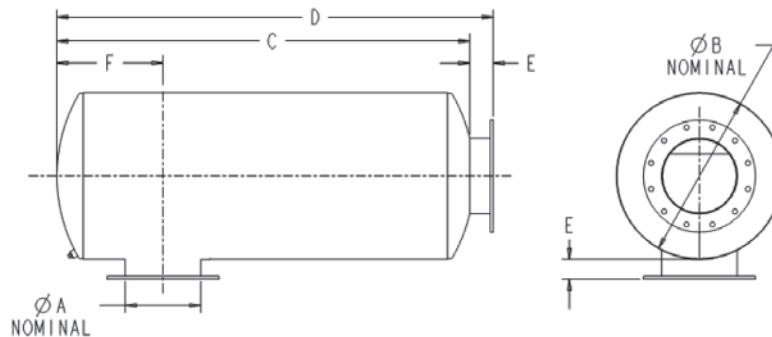

∴ 2"–3.5" connections have NPT male connections.

A Inlet Size	Connection Type	Part Number	B Silencer Diameter	C Body Length	D Overall Length	E Inlet/Outlet Length	F Inlet Offset	Weight
2	NPT	63202	5	12.5	14.5	2	4	10
2.5	NPT	63225	6	15	18	3	4	16
3	NPT	63203	8	20	23	3	5	25
3.5	NPT	63235	8	20	23	3	5	32
4	Flange	63204	10	25	28	3	6	45
5	Flange	63205	12	30	34	4	7	65
6	Flange	63206	14	35	39	4	8	95
8	Flange	63208	18	45	49	4	10	170
10	Flange	63210	22	55	59	4	12	260
12	Flange	63212	26	65	69	4	14	375
14	Flange	63214	30	75	79	4	15	510
16	Flange	63216	36	90	94	4	20	670
18	Flange	63218	42	105	109	4	22	845
20	Flange	63220	42	105	109	4	24	1040
22	Flange	63222	48	120	124	4	26	1260

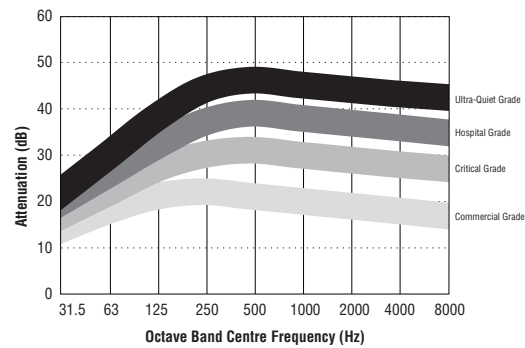
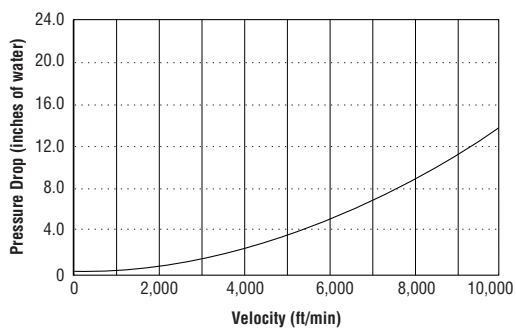

Actual performance data may vary.

∴ All dimensions are in inches unless otherwise stated. All weights are in lbs and are approximate.

∴ All information correct at time of printing. Universal has a policy of continuous improvement. Therefore we reserve the right to change the specifications of these silencers without notice.