

CUSTOMER APPROVAL SIGNATURE	APPROVAL DATE	COMMENTS
<b>INCLUDED FEATURES</b>	<b>PART #</b>	<b>WEIGHT</b>
ENGINE PERKINS 4020-15G (Grade for through flywheel)	0665996	435 Lbs.
ALTERNATOR: MARATHON 282CS1504	282CS1504	250 Lbs.
SUB-BASE: STRUCTURAL STEEL	V10897375	126 Lbs.
ISOLATORS: (4) Barry Controls 256416	V1256416	4 Lbs.
ENCLOSURE: CLAY POWDER COAT, 14 GA. STEEL SOUND ATTENUATED ENCLOSURE	V16R08469	465 Lbs.
SILENCER: SIDE-IN TOP-OUT VERTICAL MOUNT INTERNALLY MOUNTED	V162302	19 Lbs.
(3) BATTERIES: GROUP 26 STYLE 12V BATTERY RACK AND CABLES FOR BATTERY Note: Rack is integral to the skid	V16026	30 Lbs.
CIRCUIT BREAKER: AMP ABB ABB ENCLOSURE		MISC. MISC.
FUEL LINES/FITTINGS	V16R03135	MISC.
FLUID DRAIN EXTENSION: WITH VALVE ROUTED TO SKID	V17108N	MISC.
CONTROL PANEL		MISC.
HARDWARE: BOLTS, NUTS, WASHERS, LATCHES		MISC.
FLUIDS: OIL & ANTIFREEZE		MISC.
WEIGHT SUBTOTAL		1,329 Lbs.
MISC. WEIGHT 5% of subtotal		66 Lbs.
TOTAL WEIGHT:		1,395 Lbs.

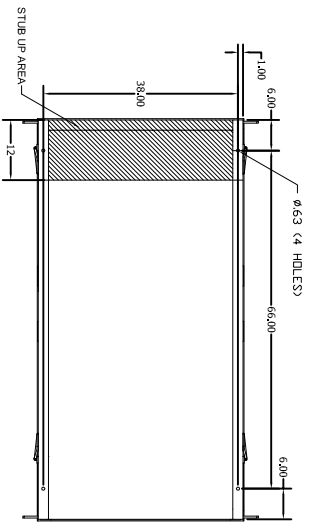
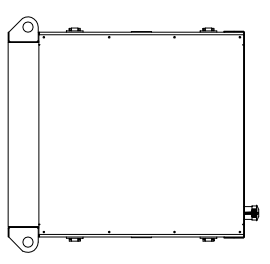
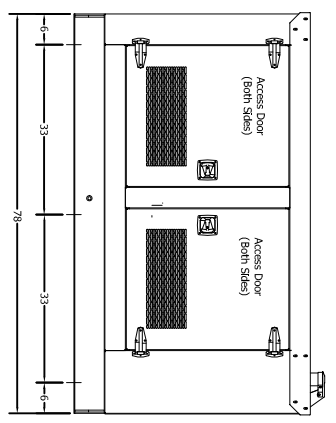
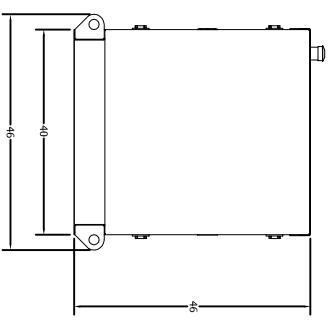
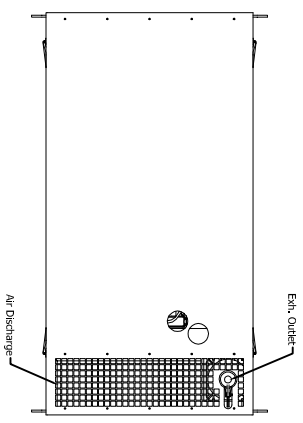

ENCLOSURE MATERIAL: 14 ga. Galvalume  
 COLOR: AkzoNobel Clay #20-8247HY POWDER COAT

DESIGN	DATE	TITLE
DESIGNED	8-31-11	TAYLOR POWER SYSTEMS
CHECKED		
QA		
APPROVED		
SIZE		
SCALE		

TD13 SOUND ATTENUATED ENCLOSURE