

CUSTOMER APPROVAL SIGNATURE	APPROVAL DATE	COMMENTS
INCLUDED FEATURES		PART #
ENGINE: PERKINS 4030-15G (radiator through flywheel)		WEIGHT
ALTERNATOR: MARATHON 282CS1504		435 Lbs.
SUB-BASE: STRUCTURAL STEEL		250 Lbs.
ISOLATORS: (4) Berry Controls 256416		126 Lbs.
ENCLOSURE: CLAY POWDER COAT, 14 GA. STEEL STANDARD ENCLOSURE		465 Lbs.
FUEL TANK: UL142 80 GALLON DOUBLE WALL		510 Lbs.
SILENCER: SIDE-IN TIP-OUT VERTICAL MOUNT INTERNALLY MOUNTED		19 Lbs.
(3) BATTERIES: GROUP 26 STYLE 12V BATTERY RACK AND CABLES FOR BATTERY Note: Rack is integral to the skid		30 Lbs.
CIRCUIT BREAKER: AMP ABB ABB ENCLOSURE		MISC.
FUEL LINES/FITTINGS		MISC.
FLUID BRAIN EXTENSION, WITH VALVE ROUTED TO SKID CONTROL PANEL		MISC.
HARDWARE: BOLTS, NUTS, WASHERS, LATCHES		MISC.
FLUIDS OIL & ANTIFREEZE		MISC.
WEIGHT SUBTOTAL		1,839 Lbs.
MISC. WEIGH. SZ. of subtotal		92 Lbs.
TOTAL WEIGHT:		1,931 Lbs.

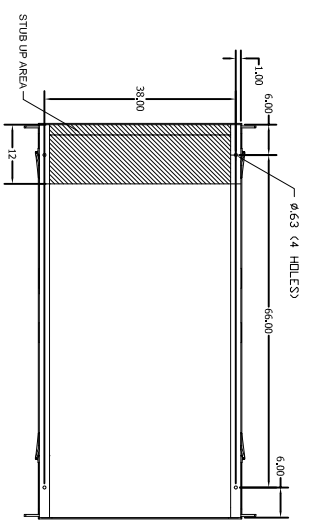
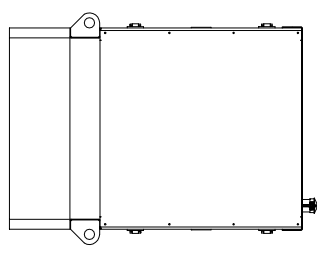
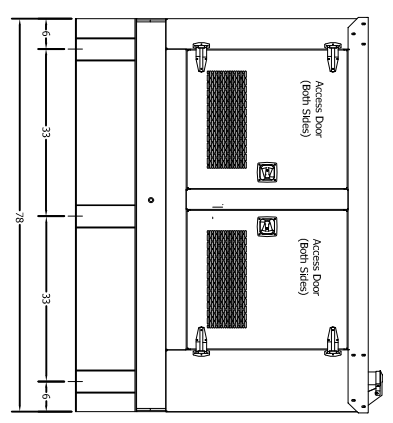
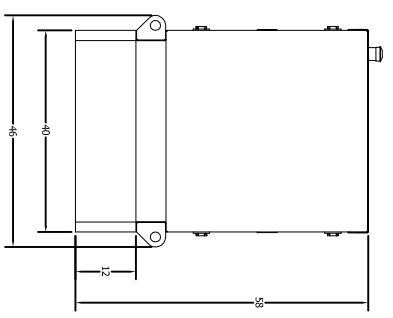
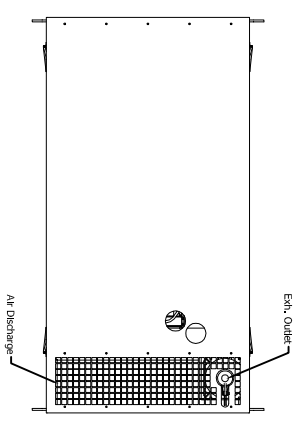

ENCLOSURE MATERIAL: 14 ga. Galvaneal  
 COLOR: Akzonobel Clay #20-8247HY POWDER COAT

DESIGN	DATE	TITLE
DRAWN	8-31-11	TAYLOR POWER SYSTEMS
CHECKED		
QA		
DESIGNED		
APPROVED		
SIZE	DWG. NO.	REV.
SCALE		

TD13 STANDARD ENCLOSURE  
 WITH 80 GALLON BASETANK