

CUSTOMER APPROVAL SIGNATURE	APPROVAL DATE	COMMENTS
<b>INCLUDED FEATURES</b>		
ENGINE: PERKINS 4040-22TAG (Generator through flywheel)	4040-22TAG	675 Lbs.
ALTERNATOR: MARATHON 283CCL1507	283CCL1507	350 Lbs.
SUB-BASE: STRUCTURAL STEEL	V1087375	126 Lbs.
ISOLATORS: (4) Barry Controls C56416	V1256416	4 Lbs.
ENCLOSURE: CLAY POWDER COAT, 14 GA. STEEL SOUND ATTENUATED ENCLOSURE	VTGRU08459	465 Lbs.
FUEL TANK: UL142 80 GALLON DOUBLE WALL	V1144078	510 Lbs.
SILENCER: SIDE-IN TOP-OUT VERTICAL MOUNT INTERNALLY MOUNTED	V162302	19 Lbs.
(1) BATTERIES: GROUP 26 STYLE 12V BATTERY RACK AND CABLES FOR BATTERY NOTE: BOLT IS INTEGRAL TO THE SKID	V16026	30 Lbs.
CIRCUIT BREAKER: ABB BREAKER ABB ENCLOSURE	VTGRU0335	MISC.
FUEL LINES/FITTINGS	VTGRU0335	MISC.
FLUID BRAIN EXTENSION: WITH VALVE ROUTED TO SKID	V11008N	MISC.
CONTROL PANEL		MISC.
HARDWARE: BOLTS, NUTS, WASHERS, LATCHES		MISC.
FLUIDS OIL & ANTIFREEZE		MISC.
WEIGHT SUBTOTAL		2179 Lbs.
MISC. WEIGHT % of subtotal		109 Lbs.
TOTAL WEIGHT:		2,288 Lbs.

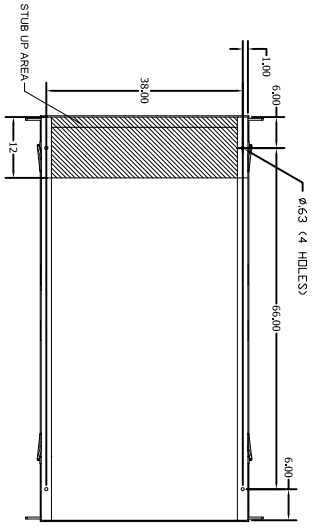
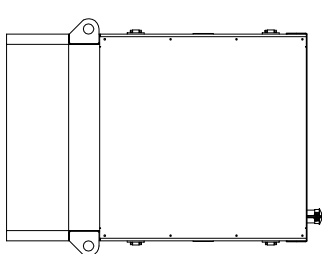
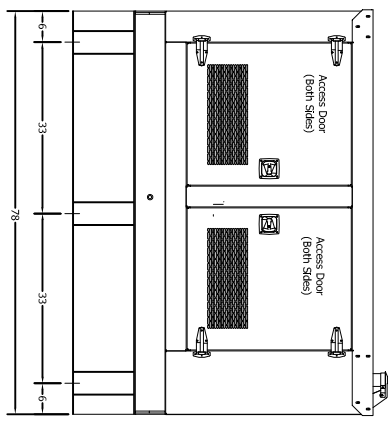
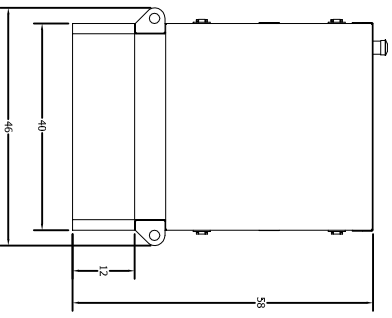
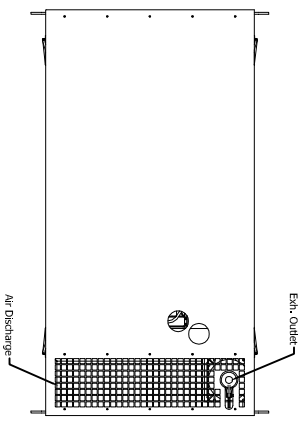

DESIGN	8-31-11	TITLE	TAYLOR POWER SYSTEMS
CHECKED			
DATE			
APPROVED			
SCALE			
REV			

TD30 SOUND ATTENUATED ENCLOSURE WITH 80 GALLON BASETANK