

CUSTOMER APPROVAL SIGNATURE	APPROVAL DATE	COMMENTS
INCLUDED FEATURES		PART #
ENGINE PERKINS 4030-11G (generator through flywheel)	G455598	285 Lbs.
ALTERNATOR: MARATHON 280CSL1502	280CSL1502	220 Lbs.
SUB-BASE: STRUCTURAL STEEL	V7087375	126 Lbs.
ISOLATORS: (4) Berry Controls 256416	V7256416	4 Lbs.
ENCLOSURE: CLAY POWDER COAT, 14 GA. STEEL SOUND ATTENUATED ENCLOSURE	V7ERU08459	465 Lbs.
SILENCER: SIDE-IN TOP-OUT VERTICAL MOUNT INTERNALLY MOUNTED	V762902	19 Lbs.
(3) BATTERIES: GROUP 26 STEEL 12V BATTERY 50A C/100 AMP DISCHARGE RATE Note: Rack is integral to the shld	V76205	30 Lbs.
CIRCUIT BREAKER: AMP 400 400 ENCLOSURE		MISC. MISC.
FUEL LINES/FITTINGS	V7ERU03135	MISC.
FLUID BRAIN EXTENSION WITH VALVE ROUTED TO SKID	V7F108N	MISC.
CONTROL PANEL		MISC.
HARDWARE: BOLTS, NUTS, WASHERS, LATCHES		MISC.
FLUIDS: OIL & ANTIFREEZE		MISC.
WEIGHT SUBTOTAL		1,149 Lbs.
MISC. WEIGHT 5% of subtotal		57 Lbs.
TOTAL WEIGHT:		1,206 Lbs.

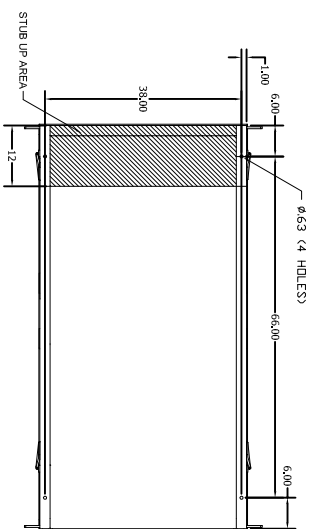
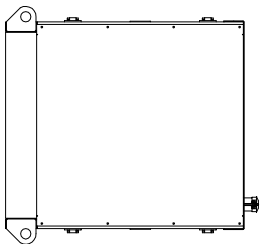
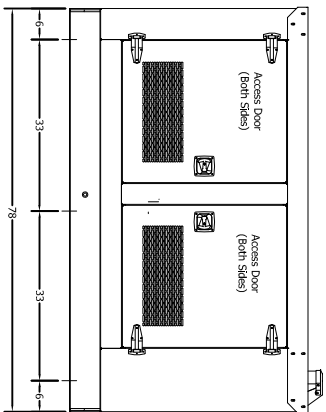
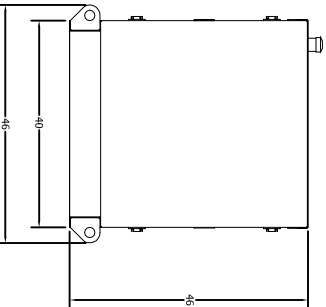
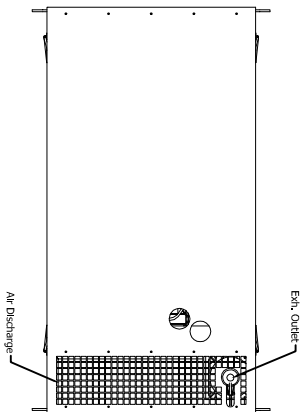

ENCLOSURE MATERIAL: 14 ga. Galvalume
COLOR: Akzonobel Clay #20-8247HY POWDER COAT

DATE	BY	TITLE
8-31-11	JMM	TAYLOR POWER SYSTEMS
	GA	TD9 SOUND ATTENUATED ENCLOSURE
	APPROVED	SIZE
		SCALE